

SelectTech 2080 Barbell: How do I keep the weights from dropping during use?

ID: 12136.4

Follow this troubleshooting guide to help resolve issues dropping weights on the SelectTech 2080 Barbell.

Some common complaints may include:

- Weight falls off during use
- Weight plates dropping
- Weights won't stay on the bar

Follow these steps to troubleshoot the issue

Tools you may need:

6mm hex/Allen wrench, or the wrench included with your barbell

1. Check that the levelers are tight against the floor and that the base is level. Adjust the levelers if needed to get the base level. They should all be in contact with the floor and the base plate bolts should be off of the floor surface [\[12136.A\]](#).
2. For the rest of this guide, perform all troubleshooting steps on both the barbell and curlbar.
3. Adjust the cradles. Loosen the bolts holding the cradles using a 6mm Allen wrench (**reference 1**). Shift each bar side to side while engaged with all weight plates. Tighten the bolts with the 6mm Allen wrench and test for plates dropping again [\[12136.D\]](#).

(Reference 1)

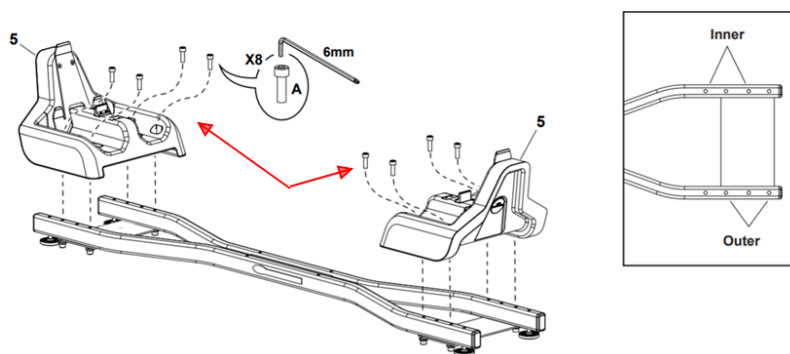

The red arrows indicate the locations of the bolts to adjust the cradles.

4. Test each selection dial separately by removing the bar from the base and placing it upside down on the floor. Push in the release post (**reference 2**) and turn the selection dial to select a weight. Test to see if the plates drop [\[12136.B\]](#).

(Reference 2)



Press the release pin in (circled in red) while turning the selection dial.

5. If it only happens on one dial, flip the bar from end to end to see if the issue follows one selection dial or if both dials are affected. If the issue follows the affected selection dial when swapped, [order a Selection Knob and Housing](#) for the affected knob [\[12136.C\]](#). If both dials are affected, [order a Curl Bar or Barbell Handle](#) (whichever bar is affected) [\[12136.E\]](#).
6. Reassemble your barbell and perform a lock test here: [SelectTech 2080 Barbell: How do I perform a lock test?](#)

Need to order replacement parts?

1 Customer Care Contact Information

Please contact Customer Care at 1-800-605-3369 for additional help or to order replacement parts. Some replacement parts may also be available for purchase [online here](#). A list of part numbers referenced within this guide can be located at the bottom of this page.

Customer Care - Hours of Operation:
Monday - Friday 6:00am - 5:00pm PST

The replacement part will be provided to you at no cost assuming your machine meets the warranty eligibility requirements. A Customer Care Agent will be able to assess your current warranty eligibility and provide you with your options. Please note that if you did not purchase your machine directly from BowFlex, Schwinn, or Nautilus, we will need a copy of your purchase receipt in order to register your machine for warranty.

2 Parts Reference Table

<i>Part Description</i>	<i>Part SKU</i>
Handle, Curl Bar	8022885
Handle, Barbell	8022884
Selection Knob and Housing	8025469

3 Contact Tech Team / Advanced Troubleshooting

If the issue was not resolved in the steps listed, contact the Tech Team or send an Advanced Troubleshooting case.

Submit a Case with case type Advanced Troubleshooting