

Table of Contents

Section Code	Section	Page Number
1	General Warnings and Troubleshooting	2
1	Important Safety Instructions	2
1	Safety Warning Labels and Serial Number	3
1	Specifications	4
1	Moving the Machine	5
1	Leveling the Machine	5
1	Connectivity	6
1	Maintenance	7
1	Maintenance Parts	8
1	Troubleshooting	10
1	Replacement Procedure Skill Level	13
	Mechanical Procedures	
2	Adjust the Drive Belt Tension	14
3	Set the Brake Tension	18
	Part Replacement	
4	Brake Assembly	22
5	Console	26
6	Console Mast	29
7	Crank Arm	34
8	Drive Belt	37
9	Input/Output Cable	42
10	Pedals and Legs	47
11	Power Inlet	50
12	Rail Assembly	53
13	Servo Motor	57
14	Shrouds	63
15	Speed Sensor	66
16	Tensioner Assembly	69
17	Upper and Lower Handlebar Arms	73
18	Transport Wheel	76

NOTICE: This document provides important safety instructions, adjustments, and general troubleshooting information for the maintenance of the Schwinn® 411 / 510e Elliptical .

If you need assistance, please contact Customer Service (if purchased in US/Canada) or your local distributor (if purchased outside US/Canada). To find your local distributor, go to: www.nautilusinternational.com

 This icon means a potentially hazardous situation which, if not avoided, could result in death or serious injury. Read and understand all Warnings on this machine.

Nautilus, Inc., www.NautilusInc.com, 5415 Centerpoint Parkway, Groveport, OH 43125 U.S.A. - Customer Service: North America (800) 605-3369, csnls@nautilus.com | outside U.S. www.nautilusinternational.com | Printed in China | © 2018 Nautilus, Inc. | Schwinn, the Schwinn logo, and Schwinn Toolbox are trademarks owned or licensed by Nautilus, Inc., registered or otherwise protected by common law in the United States and other nations. App Store is a service mark of Apple Inc. Google Play™, and MyFitnessPal® are trademarks of their respective owners. The Bluetooth® word mark and logos are registered trademarks owned by Bluetooth SIG, Inc., and any use of such marks by Nautilus, Inc. is under license. | **ORIGINAL DOCUMENT - ENGLISH VERSION ONLY**

Important Safety Instructions

 This icon means a potentially hazardous situation which, if not avoided, could result in death or serious injury. Read and understand all Warnings on this machine.

Before servicing or using this equipment, obey the following warnings:

 Read and understand the Service Manual before working on the machine. Failure to obey the instructions and safety warnings could cause injury to the service technician or bystanders.

⚠ DANGER To reduce the risk of electrical shock or unsupervised usage of the equipment, always unplug the AC Adapter from the wall outlet and/or the machine before cleaning, maintaining or repairing the machine. Place the AC Adapter in a secure location.

- Keep bystanders and children away from the product being serviced at all times.
- Make sure that the repair is done in an appropriate work space away from foot traffic and exposure to bystanders.
- Some components of the equipment can be heavy or awkward. Enlist the service of a second person when you do maintenance steps involving these components. Do not try to do heavy or awkward steps on your own.
- Use only replacement parts and hardware that are supplied or approved by Nautilus. Failure to use Nautilus-approved replacement parts can adversely affect the safety and functionality of the equipment creating a risk to users and will void the warranty.
- Be sure that all warning stickers and instructional placards applied to the product stay present and in good condition when doing maintenance or replacing components. If at any time the Warning labels become loose, unreadable or dislodged, replace the labels. If purchased in US/Canada, contact Customer Service for replacement labels. If purchased outside US/Canada, contact your local distributor for them.
- Do not try to change the design or functionality of the machine being serviced as this can adversely affect user safety and will void the warranty.
- Do not put the machine back in service until all shrouds, instructions, warning labels and correct functionality have been verified and tested for correct performance.

SAFETY WARNING LABELS AND SERIAL NUMBER

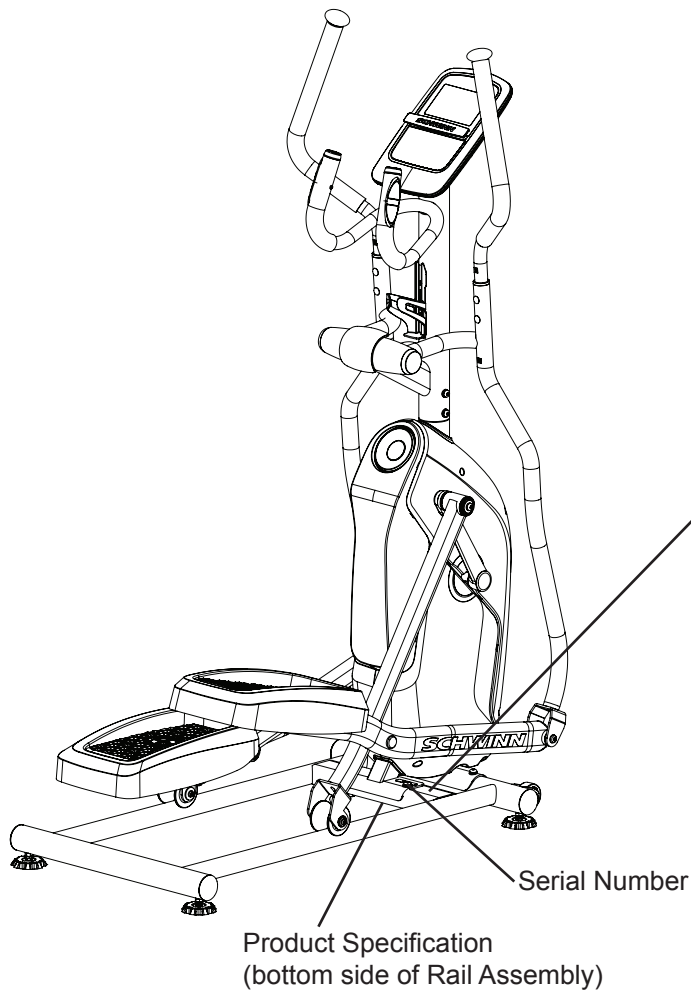

WARNING!

- Injury or death is possible if caution is not used while using this machine.
- Keep children and pets away.
- Read and follow all warnings on this machine.
- Refer to the Owner's Manual for additional warnings and safety information.
- The heart rate displayed is an approximation and should be used for reference only.
- Not intended for use by anyone under 14 years of age.
- The maximum user weight for this machine is 300 lbs (136 kg).
- This machine is for home use only.
- Consult a physician prior to using any exercise equipment.

(Label is available in English and French Canadian only.)

FCC Compliance

- ⚠** Changes or modifications to this unit not expressly approved by the party responsible for compliance could void the user's authority to operate the equipment.

The machine and power supply comply with Part 15 of the FCC rules. Operation is subject to the following two conditions: (1) This device may not cause harmful interference, and (2) this device must accept any interference received, including interference that may cause undesired operation.

Note: This machine and power supply have been tested and found to comply with the limits for a Class B digital device, pursuant to Part 15 of the FCC Rules. These limits are designed to provide reasonable protection against harmful interference in a residential installation. This equipment generates, uses and can radiate radio frequency energy and, if not installed and used in accordance with the instructions, may cause harmful interference to radio communications.

However, there is no guarantee that interference will not occur in a particular installation. If this equipment does cause harmful interference to radio or television reception, which can be determined by turning the equipment off and on, the user is encouraged to try to correct the interference by one or more of the following measures:

- Reorient or relocate the receiving antenna.
- Increase the separation between the equipment and receiver.
- Connect the equipment into an outlet on a circuit different from that to which the receiver is connected.
- Consult the dealer or an experienced radio/TV technician for help.

SPECIFICATIONS

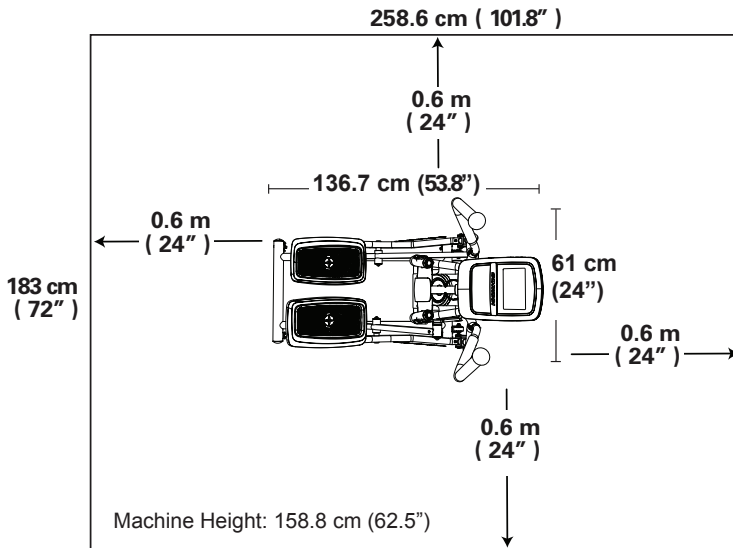

Maximum User Weight: 136 kg (300 lbs.)
Maximum Pedal Height: 43.2 cm (17")
Machine Weight: 45.8 kg (101 lbs.)

Total Surface Area (footprint) of equipment: 8180.1 cm²

Power Requirements:

Input Voltage: 100-240V AC, 50-60Hz, 0.4A
Output Voltage: 9V DC, 1.5A



DO NOT dispose of this product as refuse. This product is to be recycled. For proper disposal of this product, please follow the prescribed methods at an approved waste center.

Moving the Machine

! The machine may be moved by one or more persons depending on their physical abilities and capacities. Make sure that you and others are all physically fit and able to move the machine safely.

1. Remove the AC Adapter.
2. Use the Transport Handle to carefully lift the machine onto the transport rollers.
3. Push the machine into position.
4. Carefully lower the machine into position.

NOTICE: Be careful when you move the elliptical. Abrupt motions can affect the computer operation.

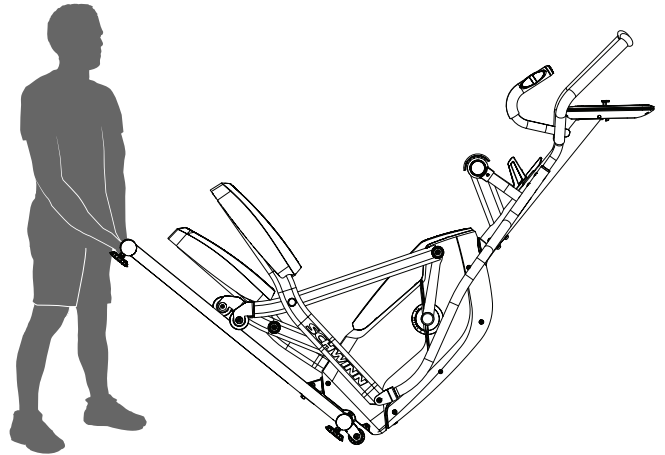

Leveling the Machine

The machine needs to be leveled if your workout area is uneven or if the Rail Assembly is slightly off the floor. To adjust:

1. Place the machine in your workout area.
2. Safely stand on the back of the Rail Assembly for approximately 20 seconds.
3. Step off the machine.
4. Loosen the locking nuts and adjust the levelers until they all contact the floor.

! Do not adjust the levelers to such a height that they detach or unscrew from the machine. Injury to you or damage to the machine can occur.

5. Adjust until the machine is level. Tighten the locking nuts.

Make sure the machine is level and stable before you exercise.

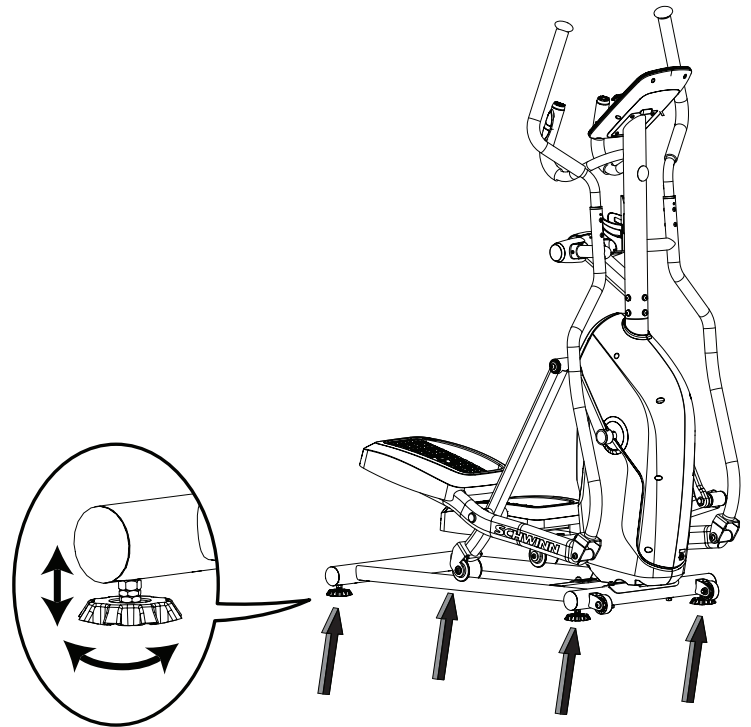

Updates to Your Machine using the “Schwinn Toolbox™” App

This fitness machine is equipped with Bluetooth® connectivity and can be wirelessly updated with the “Schwinn Toolbox™” App. Once the App is installed on your device, the App will inform you of when there is an update to your machine.

1. Download the free App, named Schwinn Toolbox™. The App is available on the App Store and Google Play™.

Note: For a complete list of supported devices, review the App on the App Store or Google Play™.

2. Install the App.

When notified that there is an update to your fitness machine, follow the prompts on the App. Place the device that is running the App on the Media Tray. The App will update the software on the machine with the latest version. Do not remove your device from the Media Tray until the update is complete. The machine will return to the Welcome Screen when the update is completed.

Workout with Other Fitness Apps

This fitness machine has integrated Bluetooth® connectivity which allows it to work with a number of digital partners. For our latest list of supported partners, please visit: www.nutilus.com/partners

Bluetooth® Heart Rate Chest Strap (not supplied)

Your fitness machine is equipped to be able to receive a signal from a Bluetooth® Heart Rate Chest Strap. When connected, the Console will display the Bluetooth® Heart Rate Chest Strap Connected icon.

 **If you have a pacemaker or other implanted electronic device, consult your doctor before using a Bluetooth® chest strap or other Bluetooth® heart rate monitor.**

1. Put on your Bluetooth® Heart Rate Chest Strap and activate it.
2. Push the Connect Bluetooth® button. The Console will actively search for any devices in the area. The Bluetooth® Heart Rate Chest Strap Connected icon will flash on the Console while searching.

Note: Any previously connected Chest Straps will be disconnected. However, if they are within range, the Console may find them again if unable to locate your Chest Strap.

3. The Bluetooth® Heart Rate Chest Strap Connected icon will stop blinking when connected. You are ready to workout.

At the end of your workout, push the Connect Bluetooth® button to disconnect your Chest Strap from the Console.

MAINTENANCE

Read all maintenance instructions fully before you start any repair work. In some conditions, an assistant is required to do the necessary tasks.

⚠ Equipment must be regularly examined for damage and repairs. The owner is responsible to make sure that regular maintenance is done. Worn or damaged components must be repaired or replaced immediately. Only manufacturer supplied components can be used to maintain and repair the equipment.

If at any time the Warning labels become loose, unreadable or dislodged, replace the labels. If purchased in US/Canada, contact Customer Service for replacement labels. If purchased outside US/Canada, contact your local distributor for them.

⚠ DANGER To reduce the risk of electrical shock or unsupervised usage of the equipment, always unplug the power cord from the wall outlet and the machine and wait 5 minutes before cleaning, maintaining or repairing the machine. Place the AC Adapter in a secure location.

Daily: Before each use, examine the exercise machine for loose, broken, damaged, or worn parts. Do not use if found in this condition. Repair or replace all parts at the first sign of wear or damage. After each workout, use a damp cloth to wipe your machine and Console free of moisture.

Note: Avoid excessive moisture on the Console.

Weekly: Check for smooth roller operation. Wipe the machine to remove dust, dirt, or grime. Clean the rails and surface of the rollers with a damp cloth. Apply silicone lubricant to a dry cloth and wipe the rails to eliminate roller noise.

⚠ Silicone lubricant is not intended for human consumption. Keep out of reach of children. Store in a safe place.

Note: Do not use petroleum based products.

Monthly or after 20 hours: Make sure all bolts and screws are tight. Tighten as necessary.

NOTICE: Do not clean with a petroleum based solvent or an automotive cleaner. Be sure to keep the Console free of moisture.

Maintenance Parts

A	Console	N	Left Front Shroud	AA	Handlebar Arm, Lower Right
B	Console Mast	O	Right Front Shroud	BB	Pedal Arm, Right
C	Console Cable, Upper	P	Rail Assembly	CC	Speed Sensor
D	Rear Shroud	Q	Transport Wheel	DD	Servo Motor
E	Right Side Shroud	R	Leveler	EE	Brake Assembly
F	Console Cable, Lower	S	Roller	FF	Power Inlet
G	Frame Assembly	T	Leg, Right	GG	Fly Wheel
H	Left Side Shroud	U	Crank Arm, Right	HH	Tensioner
I	Crank Arm, Left	V	Handlebar Shroud, Right	II	Drive Belt
J	Leg, Left	W	Handlebar Shroud, Left	JJ	Speed Sensor Magnet
K	Handlebar Arm, Upper Left	X	Pivot Shroud	KK	Drive Pulley
L	Handlebar Arm, Lower Left	Y	Water Bottle Holder	LL	Silicone Lubricant, Bottle
M	Pedal Arm, Left	Z	Handlebar Arm, Upper Right		

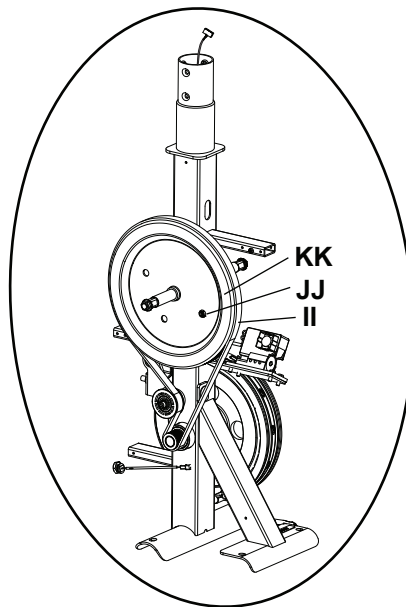
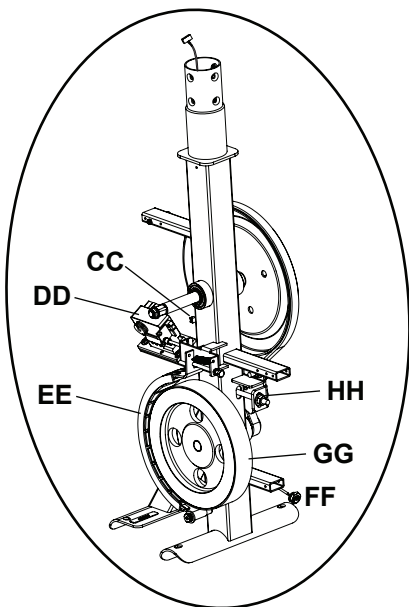
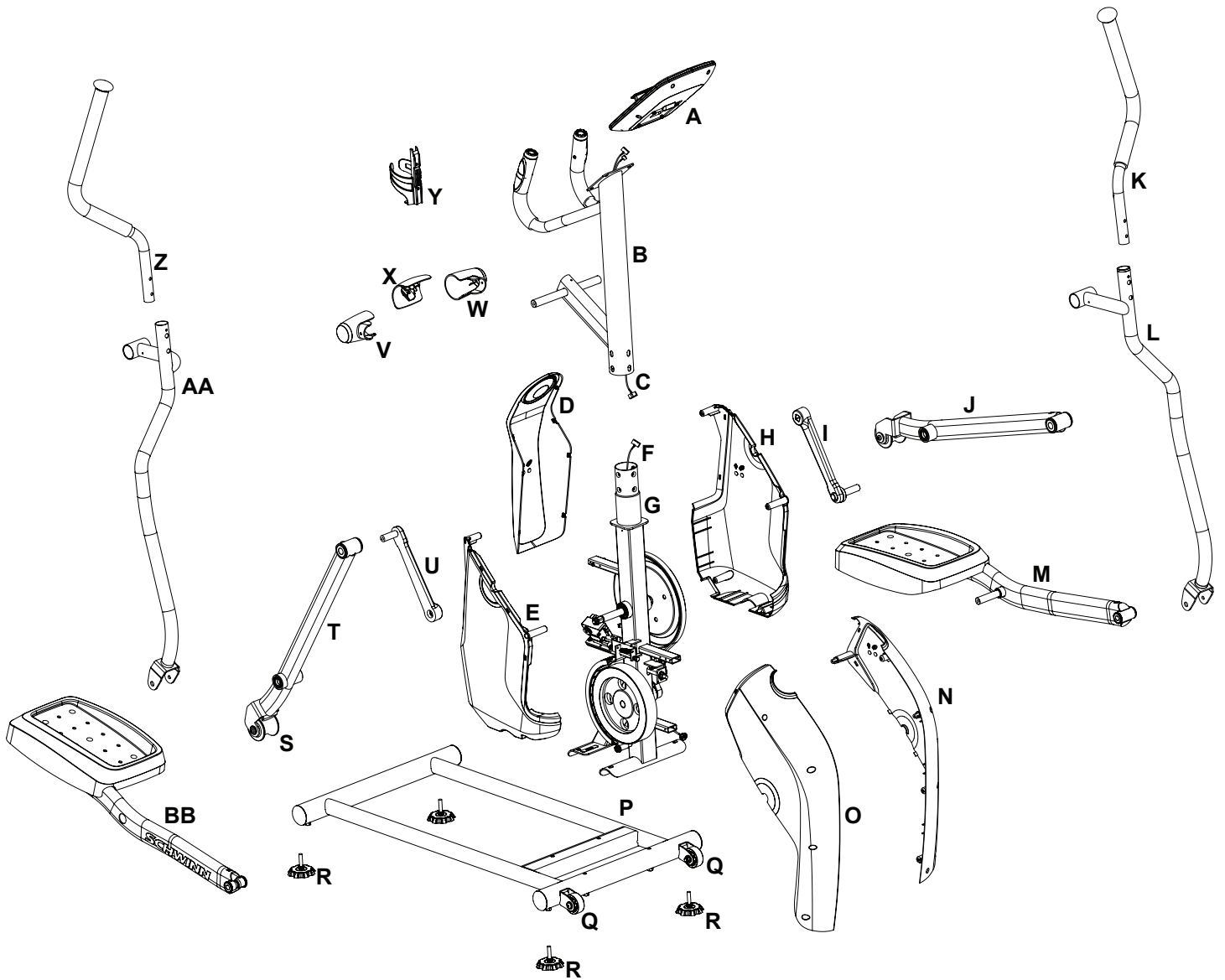

TROUBLESHOOTING

Condition/Problem	Things to Check	Solution
No display/partial display/ unit will not turn on	Check electrical (wall) outlet	Make sure unit is plugged into a functioning wall outlet.
	Check connection at front of unit	Connection should be secure and undamaged. Replace adapter or connection at unit if either are damaged.
	Check data cable integrity	All wires in cable should be intact. If any are visibly crimped or cut, replace cable.
	Check data cable connections/orientation	Be sure cable is connected securely and oriented properly. Small latch on connector should line up and snap into place.
	Check console display for damage	Check for visual sign that console display is cracked or otherwise damaged. Replace Console if damaged.
	Console Display	If Console only has partial display and all connections are fine, replace the Console.
		If the above steps do not resolve the problem, contact Customer Service (if inside US/Canada) or your local distributor (if outside US/Canada).
Unit operates but Contact HR not displayed	HR cable connection at Console	Be sure cable is connected securely to Console.
	HR cable box connection	Be sure cables from handlebars and cable to Console are secure and undamaged.
	Sensor grip	Be sure hands are centered on HR sensors. Hands must be kept still with relatively equal pressure applied to each side.
	Dry or calloused hands	Sensors may have difficulty with dried out or calloused hands. A conductive electrode cream (heart rate cream) can help make better conduct. These are available on the web or at medical or some larger fitness stores.
	Static Handlebar	If tests reveal no other issues, Static Handlebar should be replaced.
Unit operates but Bluetooth® HR not displayed	Chest Strap (not provided)	Make sure strap is directly against skin and contact area is wet.
	Chest Strap Batteries	If strap has replaceable batteries, install new batteries.
	Interference	Try moving unit away from sources of interference (TV, Microwave, etc).
	Replace Chest Strap	If interference is eliminated and HR does not function, replace strap.
	Replace Console	If HR still does not function, replace Console.
Unit operates but Bluetooth® HR displayed incorrectly	Connected to previous user	The Console may be still connected to the previous user. Push Connect Bluetooth® button to disconnect from them/ connect to your chest strap.
No speed/RPM reading, Console displays "Please Stride" error code	Check data cable integrity	All wires in cable should be intact. If any are cut or crimped, replace cable.
	Check data cable connections/orientation	Be sure cable is connected securely and oriented properly. Small latch on connector should line up and snap into place.
	Check magnet position (requires shroud removal)	Magnet should be in place on pulley.
	Check Speed Sensor (requires shroud removal)	Speed sensor should be aligned with magnet and connected to data cable. Realign sensor if necessary. Replace if there is any damage to the sensor or the connecting wire.

Condition/Problem	Things to Check	Solution
Resistance does not change (machine turns on and operates)	Check Console	Check for visual sign that Console is damaged. Replace Console if damaged.
	Check data cable integrity	All wires in cable should be intact. If any are visibly crimped or cut, replace cable.
	Check data cable connections/orientation	Be sure cable is connected securely and oriented properly. Reseat all connections. Small latch on connector should line up and snap into place.
	Check Servo Motor (requires shroud removal)	If magnets move, adjust until they are within the proper range. Replace Servo Motor if not functioning properly.
		If the above steps do not resolve the problem, contact Customer Service (if inside US/Canada) or your local distributor (if outside US/Canada) for further assistance.
Console shuts off (enters sleep mode) while in use	Check electrical (wall) outlet	Make sure unit is plugged into a functioning wall outlet.
	Check connection at front of unit	Connection should be secure and undamaged. Replace adapter or connection at unit if either are damaged.
	Check data cable integrity	All wires in the cable should be intact. If any are cut or crimped, replace cable.
	Check data cable connections/orientation	Be sure cable is connected securely and oriented properly. Small latch on connector should line up and snap into place.
	Reset machine	Unplug unit from electrical outlet for 3 minutes. Reconnect to outlet.
	Check magnet position (requires shroud removal)	Magnet should be in place on pulley.
	Check Speed Sensor (requires shroud removal)	Speed sensor should be aligned with magnet and connected to data cable. Realign sensor if necessary. Replace if there is any damage to the sensor or the connecting wire.
Unit rocks/does not sit level	Check leveler adjustment	Adjust levelers until machine is level.
	Check surface under unit	Adjustment may not be able to compensate for extremely uneven surfaces. Move machine to level area.
Foot pedals loose/unit difficult to operate	Hardware	Tightly secure all hardware on the Pedal Arms and Handlebar Arms.
Drive train click/tick noise once per full crank revolution	Check crank/pulley assembly	Disconnect left and right foot assemblies and rotate crank. If sound persists, replace crank/pulley assembly. If sound does not come from rotating crank, check foot assemblies and upper/lower handlebars.
	Check foot assemblies, leg assemblies, handlebar assemblies	Manually move foot, leg, and handlebar assemblies to isolate sound. Replace part making sound.
	Check for loose hardware	Tightly secure all hardware on the Stabilizers and the base of the Console Mast.
Knocking sound during machine operation	Check hardware at junction between Lower Handlebar Arms, Pedals, and Legs	Make sure that the hardware is clear of any debris.

Condition/Problem	Things to Check	Solution
Squeaking noise that appears a few minutes into a workout and normally will get progressively worse as the workout continues	Bolt that connects the swing arms to the axle running through the console mast	Loosen pivot rod bolt slightly until noise goes away. White lithium grease can also be applied for a temporary fix. Contact Customer Service (if inside US/Canada) or your local distributor (if outside US/Canada) for further assistance.
	Roller squeaking on rail	Apply silicone lubricant to a dry cloth and wipe the rails to eliminate roller noise.

REPLACEMENT PROCEDURE SKILL LEVEL

Level I :	Low - very little mechanical knowledge or exposure.
Level II :	Intermediate - some experience with mechanical procedures
Level III :	Advanced - knowledgeable about mechanical procedures

⚠ DANGER To reduce the risk of electrical shock or unsupervised usage of the equipment, always unplug the power cord from the wall outlet and wait 5 minutes before cleaning, maintaining or repairing this machine. Place the power cord in a secure location.

⚠ When disposing of old parts, obey the applicable local and provincial requirements.

NOTICE: This document provides instructions to adjust the tension of the Drive Belt on the Schwinn® 411 / 510e Elliptical.

If you need assistance, please contact Customer Service (if purchased in US/Canada) or your local distributor (if purchased outside US/Canada). To find your local distributor, go to: www.nautilusinternational.com

! This icon means a potentially hazardous situation which, if not avoided, could result in death or serious injury. Read and understand all Warnings on this machine.

Nautilus, Inc., www.NautilusInc.com, 5415 Centerpoint Parkway, Groveport, OH 43125 U.S.A. - Customer Service: North America (800) 605-3369, csnls@nautilus.com | outside U.S. www.nautilusinternational.com | Printed in China | © 2018 Nautilus, Inc. | Schwinn and the Schwinn logo are trademarks owned or licensed by Nautilus, Inc., registered or otherwise protected by common law in the United States and other nations. | **ORIGINAL DOCUMENT - ENGLISH VERSION ONLY**

Important Safety Instructions - Before servicing or using this equipment, obey the following warnings:

! This icon means a potentially hazardous situation which, if not avoided, could result in death or serious injury. Read and understand all Warnings on this machine.

- Read and understand the Part Replacement Procedure before working on the machine. Failure to obey the instructions and safety warnings could cause injury to the service technician or bystanders.
- Keep bystanders, children and pets away from the product being serviced at all times.
- Make sure that the repair is done in an appropriate work space away from foot traffic and exposure to bystanders.
- Disconnect all power and allow to sit for 5 minutes before you service this machine.
- Some components of the equipment can be heavy or awkward. Enlist the service of a second person when you do maintenance steps involving these components. Do not try to do heavy or awkward steps on your own.
- If replacement parts are necessary, use only genuine Nautilus replacement parts and hardware. Failure to use genuine replacement parts can cause a risk to users, keep the machine from operating correctly and will void the warranty.
- Be sure that all warning stickers and instructional placards applied to the product stay present and in good condition when doing maintenance or replacing components. If at any time the Warning labels become loose, unreadable or dislodged, replace the labels. If purchased in US/Canada, contact Customer Service for replacement labels. If purchased outside US/Canada, contact your local distributor for them.
- Do not try to change the design or functionality of the machine being serviced as this can adversely effect user safety and will void the warranty.
- Do not use the machine until all shrouds, instructions, warning labels and correct functionality have been verified and tested for correct performance.

Tools Required (not included)

#2 Phillips screwdriver



Standard screwdriver



6mm hex wrench



10mm open faced wrench



1. Unplug the AC Adapter from the wall outlet and machine.
2. Set the resistance level to the maximum setting on the Console.
3. Unplug the AC Adapter from the wall outlet and machine.
4. Using a standard screwdriver on the small slots along the edge of the Center Engine Shroud, gently pop it off from the Frame Assembly.



5. Using a #2 Phillips screwdriver, remove the indicated screws (by ovals) from the Right Upper Engine Shroud.

Note: To assist with re-assembly, the double oval is a self-tapping screw.



6. Using a #2 Phillips screwdriver, remove the indicated screws (by ovals) from the Left Upper Engine Shroud.

Note: The Power Inlet is attached to the inside of the Left Upper Engine Shroud. Do not crimp the Power Inlet Cable.

7. Remove the Left Upper Engine Shroud.

8. Using a #2 Phillips screwdriver, remove the 4 screws that attach each of the Lower Engine Shrouds, and remove them.



9. To test the Drive Belt tension:

- Push the Drive Belt inward at the midpoint between the pulleys and measure the distance. The Drive Belt should have only 0.25" (0.64 cm) of give.

Or:

- Hold the edges of the Drive Belt at the midpoint and twist it. The Drive Belt should turn only 90 degrees (1/4 turn, to vertical).

If the tension is correct, go to Step 14.

If the tension is too loose or too tight, adjust the nut and bolt on the Tensioner Bracket (Idler Assembly).



10. Using a 6mm hex wrench, loosen the Tensioner Hardware.

11. Adjust the Tensioner Nut on the Tensioner Bolt using a 10mm open end wrench.

12. When the tension is correct, tighten the Tensioner Hardware to hold the Tensioner Bracket in position.

13. Carefully turn the Right Crank Arm and check the movement of the Drive Belt. The Crank Arms and Flywheel should move as one.

⚠ Be sure to keep fingers clear of all pinch hazards when you turn the Right Crank Arm.

Adjust the belt tension again if necessary.

14. Re-assemble the machine in the reverse order of when the parts were removed.

15. Final Inspection

Inspect your machine to ensure that all hardware is tight and components are properly assembled.

⚠ Do not use until the machine has been fully assembled and inspected for correct performance in accordance with the Owner's Manual.

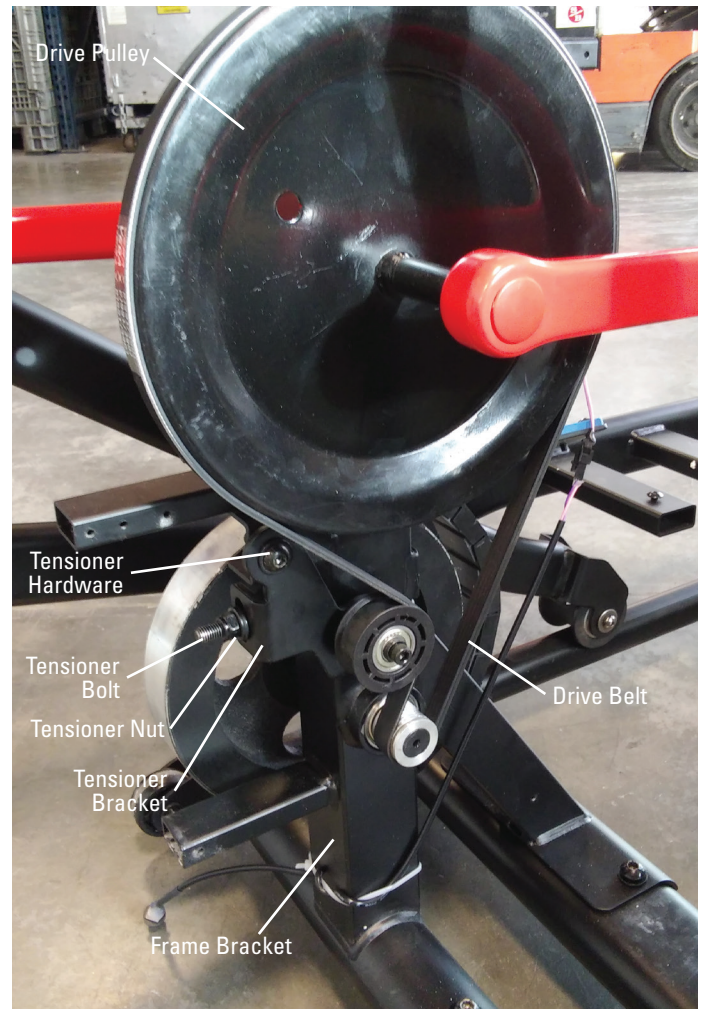

NOTICE: This document provides instructions to set the Brake Tension on the Schwinn® 411 / 510e Elliptical.

If you need assistance, please contact Customer Service (if purchased in US/Canada) or your local distributor (if purchased outside US/Canada). To find your local distributor, go to: www.nautilusinternational.com

! This icon means a potentially hazardous situation which, if not avoided, could result in death or serious injury. Read and understand all Warnings on this machine.

Nautilus, Inc., www.NautilusInc.com, 5415 Centerpoint Parkway, Groveport, OH 43125 U.S.A. - Customer Service: North America (800) 605-3369, csnls@nautilus.com | outside U.S. www.nautilusinternational.com | Printed in China | © 2018 Nautilus, Inc. | Schwinn and the Schwinn logo are trademarks owned or licensed by Nautilus, Inc., registered or otherwise protected by common law in the United States and other nations. | **ORIGINAL DOCUMENT - ENGLISH VERSION ONLY**

Important Safety Instructions - Before servicing or using this equipment, obey the following warnings:

! This icon means a potentially hazardous situation which, if not avoided, could result in death or serious injury. Read and understand all Warnings on this machine.

- Read and understand the Part Replacement Procedure before working on the machine. Failure to obey the instructions and safety warnings could cause injury to the service technician or bystanders.
- Keep bystanders, children and pets away from the product being serviced at all times.
- Make sure that the repair is done in an appropriate work space away from foot traffic and exposure to bystanders.
- Disconnect all power and allow to sit for 5 minutes before you service this machine.
- Some components of the equipment can be heavy or awkward. Enlist the service of a second person when you do maintenance steps involving these components. Do not try to do heavy or awkward steps on your own.
- If replacement parts are necessary, use only genuine Nautilus replacement parts and hardware. Failure to use genuine replacement parts can cause a risk to users, keep the machine from operating correctly and will void the warranty.
- Be sure that all warning stickers and instructional placards applied to the product stay present and in good condition when doing maintenance or replacing components. If at any time the Warning labels become loose, unreadable or dislodged, replace the labels. If purchased in US/Canada, contact Customer Service for replacement labels. If purchased outside US/Canada, contact your local distributor for them.
- Do not try to change the design or functionality of the machine being serviced as this can adversely effect user safety and will void the warranty.
- Do not use the machine until all shrouds, instructions, warning labels and correct functionality have been verified and tested for correct performance.

Tools Required (not included)

#2 Phillips screwdriver



Standard screwdriver

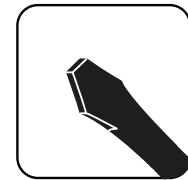

(2) 8mm open faced wrench

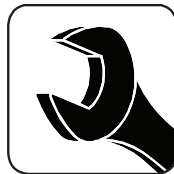

2.5" x 10" cardboard and tape



1. Turn the power on to the machine.
2. Set the resistance level to the maximum setting on the Console.
3. Unplug the AC Adapter from the wall outlet and machine.
4. Using a standard screwdriver on the small slots along the edge of the Center Engine Shroud, gently pop it off from the Frame Assembly.



5. Using a #2 Phillips screwdriver, remove the indicated screws (by ovals) from the Right Upper Engine Shroud.

Note: To assist with re-assembly, the double oval is a self-tapping screw.



6. Using a #2 Phillips screwdriver, remove the indicated screws (by ovals) from the Left Upper Engine Shroud.

Note: The Power Inlet is attached to the inside of the Left Upper Engine Shroud. Do not crimp the Power Inlet Cable.

7. Remove the Left Upper Engine Shroud.

8. Using a #2 Phillips screwdriver, remove the 4 screws that attach each of the Lower Engine Shrouds, and remove them.



9. Insert 2.5" x 10" cardboard between the Brake Magnet and the Flywheel, and tape the cardboard to the Brake Magnet.

Note: Be sure the cardboard covers all of the Brake Magnet. The cardboard will keep the Brake Magnet from grabbing onto the Flywheel.

10. Using two 8mm open faced wrenches, loosen both of the securing nuts (indicated by arrow) that secure the Brake Cable to the Brake Arm.

11. Adjust the two securing nuts (indicated by arrows) to shift the Brake Cable until the closest point of the Brake Magnet is within 3.0mm (1/8") of the Flywheel. Tighten the securing nuts.

Note: If the cardboard is not 3mm (1/8") thick, you can use the pages of a paperback book to measure the gap. Approximately 36 pages (sheets) = 3mm.

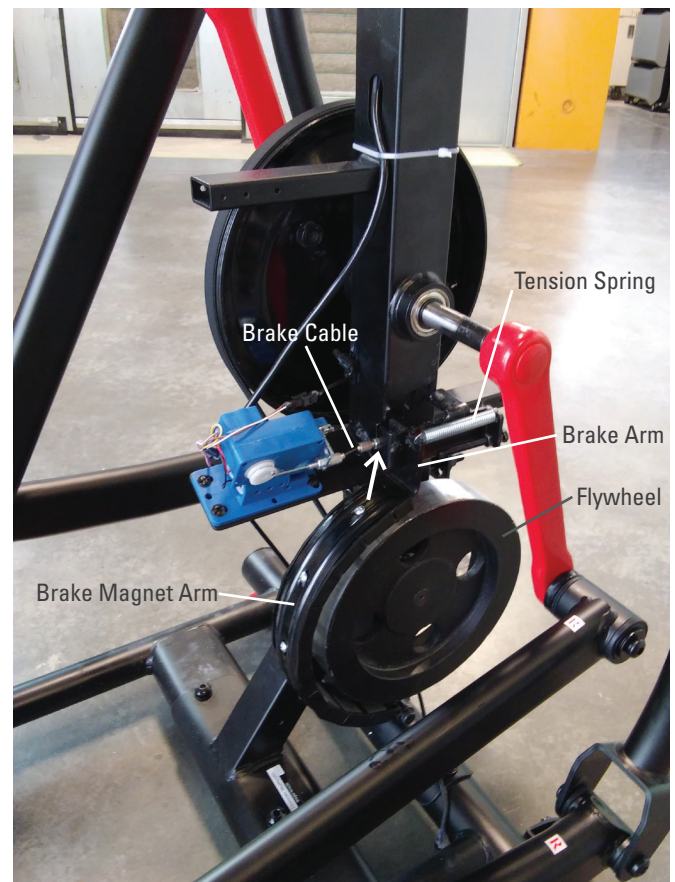

12. Remove the cardboard and tape from the Brake Assembly and Flywheel. Verify that the Brake Magnet Arm can move freely and that the Brake Magnet and Flywheel do not touch.

13. Before fully attaching the Shrouds, power up the machine to verify that the Magnet Arm can move freely, and that the Brake Magnet and Flywheel do not touch at the maximum resistance level.

⚠ Machine is on. Current is active. There is risk of electrical shock. Be sure to keep fingers clear of all pinch hazards when you change the resistance level.

14. Unplug the AC Adapter from the wall outlet and machine.

15. Re-assemble the machine in the reverse order of when the parts were removed.

16. Final Inspection

Inspect your machine to ensure that all hardware is tight and components are properly assembled.

⚠ Do not use until the machine has been fully assembled and inspected for correct performance in accordance with the Owner's Manual.

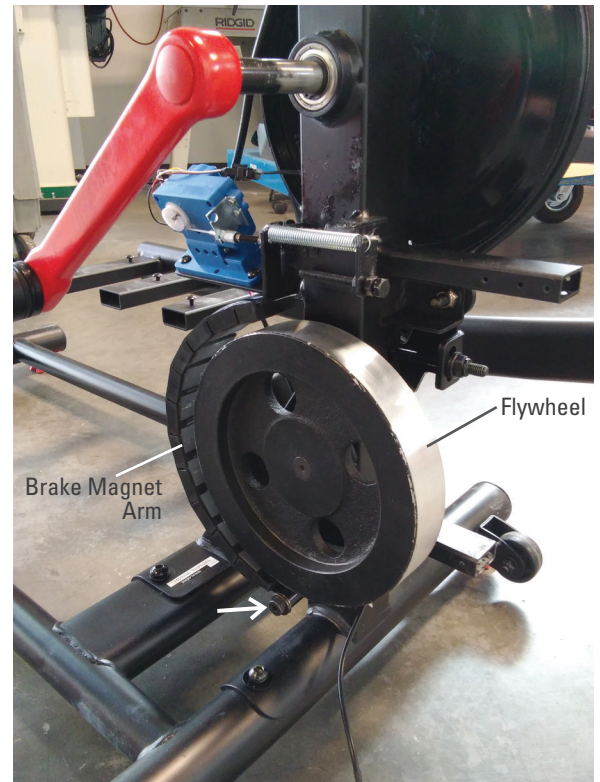

NOTICE: This document provides instructions for the replacement of the Brake Assembly on the Schwinn® 411 / 510e Elliptical.

If you need assistance, please contact Customer Service (if purchased in US/Canada) or your local distributor (if purchased outside US/Canada). To find your local distributor, go to: www.nautilusinternational.com

! This icon means a potentially hazardous situation which, if not avoided, could result in death or serious injury. Read and understand all Warnings on this machine.

Nautilus, Inc., www.NautilusInc.com, 5415 Centerpoint Parkway, Groveport, OH 43125 U.S.A. - Customer Service: North America (800) 605-3369, csnls@nautilus.com | outside U.S. www.nautilusinternational.com | Printed in China | © 2018 Nautilus, Inc. | Schwinn and the Schwinn logo are trademarks owned or licensed by Nautilus, Inc., registered or otherwise protected by common law in the United States and other nations. | **ORIGINAL DOCUMENT - ENGLISH VERSION ONLY**

Important Safety Instructions - Before servicing or using this equipment, obey the following warnings:

! This icon means a potentially hazardous situation which, if not avoided, could result in death or serious injury. Read and understand all Warnings on this machine.

- Read and understand the Part Replacement Procedure before working on the machine. Failure to obey the instructions and safety warnings could cause injury to the service technician or bystanders.
- Keep bystanders, children and pets away from the product being serviced at all times.
- Make sure that the repair is done in an appropriate work space away from foot traffic and exposure to bystanders.
- Disconnect all power and allow to sit for 5 minutes before you service this machine.
- Some components of the equipment can be heavy or awkward. Enlist the service of a second person when you do maintenance steps involving these components. Do not try to do heavy or awkward steps on your own.
- If replacement parts are necessary, use only genuine Nautilus replacement parts and hardware. Failure to use genuine replacement parts can cause a risk to users, keep the machine from operating correctly and will void the warranty.
- Be sure that all warning stickers and instructional placards applied to the product stay present and in good condition when doing maintenance or replacing components. If at any time the Warning labels become loose, unreadable or dislodged, replace the labels. If purchased in US/Canada, contact Customer Service for replacement labels. If purchased outside US/Canada, contact your local distributor for them.
- Do not try to change the design or functionality of the machine being serviced as this can adversely effect user safety and will void the warranty.
- Do not use the machine until all shrouds, instructions, warning labels and correct functionality have been verified and tested for correct performance.

Tools Required (not included)

#2 Phillips screwdriver



Standard screwdriver



(2) 8mm open faced wrenches
13mm open faced wrench
16mm open faced wrench



2.5" x 10" cardboard and tape

Needle-nose pliers



1. Unplug the AC Adapter from the wall outlet and machine.

2. Using a standard screwdriver on the small slots along the edge of the Center Engine Shroud, gently pop it off from the Frame Assembly.



3. Using a #2 Phillips screwdriver, remove the indicated screws (by ovals) from the Right Upper Engine Shroud.

Note: To assist with re-assembly, the double oval is a self-tapping screw.



4. Using a #2 Phillips screwdriver, remove the indicated screws (by ovals) from the Left Upper Engine Shroud.

Note: The Power Inlet is attached to the inside of the Left Upper Engine Shroud. Do not crimp the Power Inlet Cable.

5. Remove the Left Upper Engine Shroud.

6. Using a #2 Phillips screwdriver, remove the 4 screws that attach each of the Lower Engine Shrouds, and remove them.



7. Insert 2.5" x 10" cardboard between the Brake Magnet and the Flywheel, and tape the cardboard to the Brake Magnet.

Note: Be sure the cardboard covers all of the Brake Magnet. The cardboard will keep the Brake Magnet from grabbing onto the Flywheel.

8. Using a #2 Phillips screwdriver, remove the two screws that attach the Servo Motor Bracket to the Servo Motor.

9. Using two 8mm open faced wrenches, loosen both of the securing nuts that secure the Brake Cable to the Brake Arm.

10. Push the Brake Arm toward the Servo Motor and slide the Brake Cable out of the Brake Arm.

11. Use a pair of pliers to unhook the Tension Spring from the Main Frame. Pull back and release the Magnet Arm enough to disengage it from the Brake Cable.

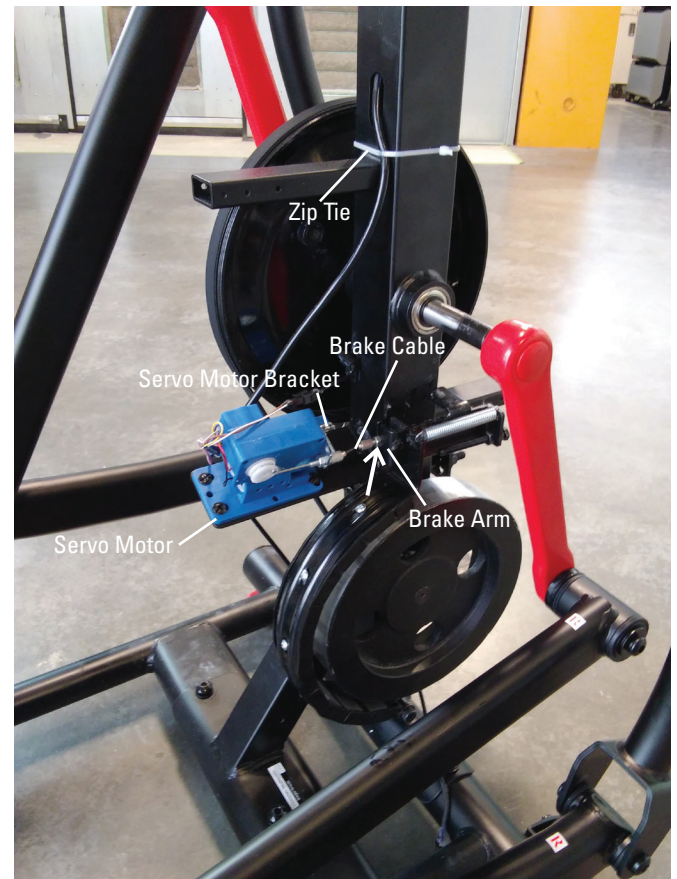

12. Loosen and remove the hardware (indicated by arrow) that attaches the Brake Assembly to the Main Frame Bracket.

NOTICE: Hold the Brake Assembly so that it does not fall.

13. Remove the old Brake Assembly and remove the cardboard.

14. Tape the cardboard to the new Brake Magnet. Be sure the cardboard will completely cover the new Brake Magnet before installation.

15. Re-assemble the machine in the reverse order of when the parts were removed.

16. Final Inspection

Inspect your machine to ensure that all hardware is tight and components are properly assembled.



Do not use until the machine has been fully assembled and inspected for correct performance in accordance with the Owner's Manual.

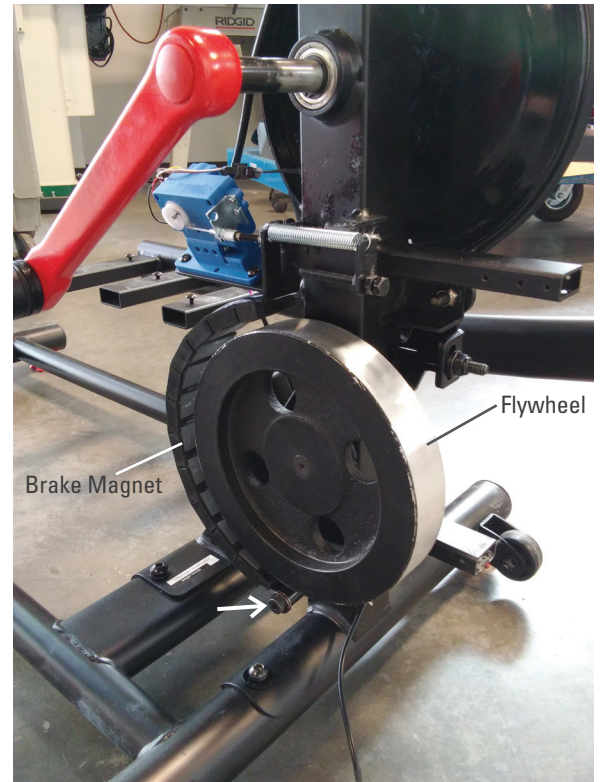

NOTICE: This document provides instructions for the replacement of the Console on the Schwinn® 411 / 510e Elliptical.

If you need assistance, please contact Customer Service (if purchased in US/Canada) or your local distributor (if purchased outside US/Canada). To find your local distributor, go to: www.nautilusinternational.com

 This icon means a potentially hazardous situation which, if not avoided, could result in death or serious injury. Read and understand all Warnings on this machine.

Nautilus, Inc., www.NautilusInc.com, 5415 Centerpoint Parkway, Groveport, OH 43125 U.S.A. - Customer Service: North America (800) 605-3369, csnls@nautilus.com | outside U.S. www.nautilusinternational.com | Printed in China | © 2018 Nautilus, Inc. | Schwinn and the Schwinn logo are trademarks owned or licensed by Nautilus, Inc., registered or otherwise protected by common law in the United States and other nations. | **ORIGINAL DOCUMENT - ENGLISH VERSION ONLY**

Important Safety Instructions - Before servicing or using this equipment, obey the following warnings:

 This icon means a potentially hazardous situation which, if not avoided, could result in death or serious injury. Read and understand all Warnings on this machine.

- Read and understand the Part Replacement Procedure before working on the machine. Failure to obey the instructions and safety warnings could cause injury to the service technician or bystanders.
- Keep bystanders, children and pets away from the product being serviced at all times.
- Make sure that the repair is done in an appropriate work space away from foot traffic and exposure to bystanders.
- Disconnect all power and allow to sit for 5 minutes before you service this machine.
- Some components of the equipment can be heavy or awkward. Enlist the service of a second person when you do maintenance steps involving these components. Do not try to do heavy or awkward steps on your own.
- If replacement parts are necessary, use only genuine Nautilus replacement parts and hardware. Failure to use genuine replacement parts can cause a risk to users, keep the machine from operating correctly and will void the warranty.
- Be sure that all warning stickers and instructional placards applied to the product stay present and in good condition when doing maintenance or replacing components. If at any time the Warning labels become loose, unreadable or dislodged, replace the labels. If purchased in US/Canada, contact Customer Service for replacement labels. If purchased outside US/Canada, contact your local distributor for them.
- Do not try to change the design or functionality of the machine being serviced as this can adversely effect user safety and will void the warranty.
- Do not use the machine until all shrouds, instructions, warning labels and correct functionality have been verified and tested for correct performance.

Tools Required (not included)

#2 Phillips screwdriver



1. Unplug the AC Adapter from the wall outlet and machine.



2. Using a #2 Phillips screwdriver, remove the four indicated screws (by arrows) from the Console.



3. Slightly lift the Console from the Console Mast and disconnect the Cables from the back of the Console.

Note: Do not crimp the Cables.

4. Re-assemble the machine in the reverse order of when the parts were removed.

5. Final Inspection

Inspect your machine to ensure that all hardware is tight and components are properly assembled.

⚠ Do not use until the machine has been fully assembled and inspected for correct performance in accordance with the Owner's Manual.

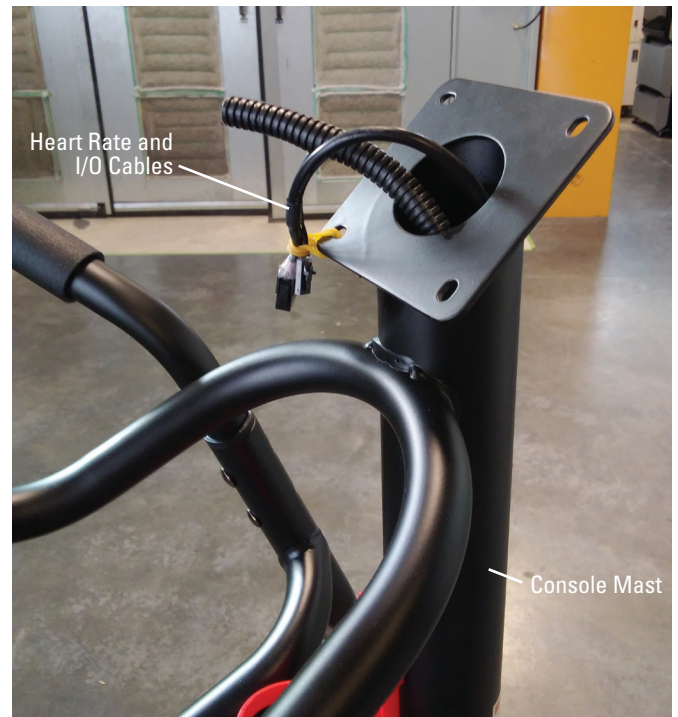

NOTICE: This document provides instructions for the replacement of the Console Mast on the Schwinn® 411 / 510e Elliptical.

If you need assistance, please contact Customer Service (if purchased in US/Canada) or your local distributor (if purchased outside US/Canada). To find your local distributor, go to: www.nautilusinternational.com

 This icon means a potentially hazardous situation which, if not avoided, could result in death or serious injury. Read and understand all Warnings on this machine.

Nautilus, Inc., www.NautilusInc.com, 5415 Centerpoint Parkway, Groveport, OH 43125 U.S.A. - Customer Service: North America (800) 605-3369, csnls@nautilus.com | outside U.S. www.nautilusinternational.com | Printed in China | © 2018 Nautilus, Inc. | Schwinn and the Schwinn logo are trademarks owned or licensed by Nautilus, Inc., registered or otherwise protected by common law in the United States and other nations. | **ORIGINAL DOCUMENT - ENGLISH VERSION ONLY**

Important Safety Instructions - Before servicing or using this equipment, obey the following warnings:

 This icon means a potentially hazardous situation which, if not avoided, could result in death or serious injury. Read and understand all Warnings on this machine.

- Read and understand the Part Replacement Procedure before working on the machine. Failure to obey the instructions and safety warnings could cause injury to the service technician or bystanders.
- Keep bystanders, children and pets away from the product being serviced at all times.
- Make sure that the repair is done in an appropriate work space away from foot traffic and exposure to bystanders.
- Disconnect all power and allow to sit for 5 minutes before you service this machine.
- Some components of the equipment can be heavy or awkward. Enlist the service of a second person when you do maintenance steps involving these components. Do not try to do heavy or awkward steps on your own.
- If replacement parts are necessary, use only genuine Nautilus replacement parts and hardware. Failure to use genuine replacement parts can cause a risk to users, keep the machine from operating correctly and will void the warranty.
- Be sure that all warning stickers and instructional placards applied to the product stay present and in good condition when doing maintenance or replacing components. If at any time the Warning labels become loose, unreadable or dislodged, replace the labels. If purchased in US/Canada, contact Customer Service for replacement labels. If purchased outside US/Canada, contact your local distributor for them.
- Do not try to change the design or functionality of the machine being serviced as this can adversely effect user safety and will void the warranty.
- Do not use the machine until all shrouds, instructions, warning labels and correct functionality have been verified and tested for correct performance.

Tools Required (not included)

#2 Phillips screwdriver



(2) 8mm open faced wrenches



(2) 6mm hex wrenches



1. Unplug the AC Adapter from the wall outlet and machine.

2. Remove the Pivot Shroud from the Frame Assembly.



3. Using a #2 Phillips screwdriver, remove the two screws that secure the Handlebar Shrouds.

4. Remove the Handlebar Shrouds from the Frame Assembly.

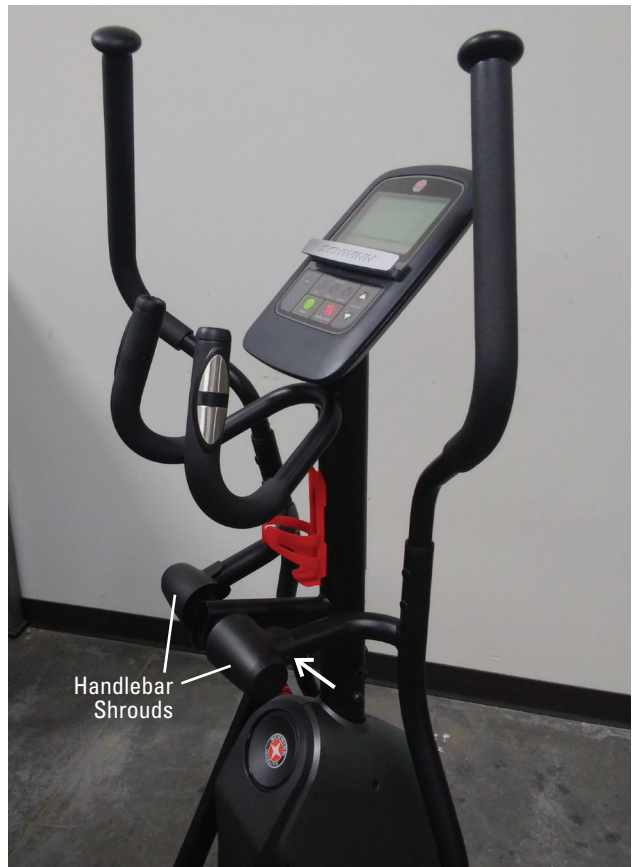

5. Using two 6mm hex wrenches, remove the indicated hardware (by arrows) that attaches the Handlebar Assemblies to the Frame Assembly and Pedal Arms.

⚠ Be aware that the Handlebar Assembly will be loose and will pivot when the hardware is removed. Safely allow the Handlebar Assembly to pivot downward and come to rest. Be sure not to be in the path of the Handlebar Assembly.

6. Carefully remove the Handlebar Assemblies from the Frame Assembly and place outside the work area.



7. Using a #2 Phillips screwdriver, remove the two indicated screws (by arrows) from the Water Bottle Holder. Be prepared to support the Holder when the screws are removed.



8. Using a #2 Phillips screwdriver, remove the four screws (indicated by arrows) that attach the Console to the Console Mast.

9. Slightly lift the Console from the Console Mast and disconnect the Cables from the back of the Console.

Note: Do not crimp the Cables.



10. Using a 6mm hex wrench, remove the 6 sets of hardware (indicated by oval) from the Console Mast.

11. Slightly lift the Console Mast from the Frame Assembly and disconnect the Cables. Fully remove the old Console Mast with Cables.

Note: Do not crimp the Cables. Do not allow the Cable to fall into the Frame Assembly.

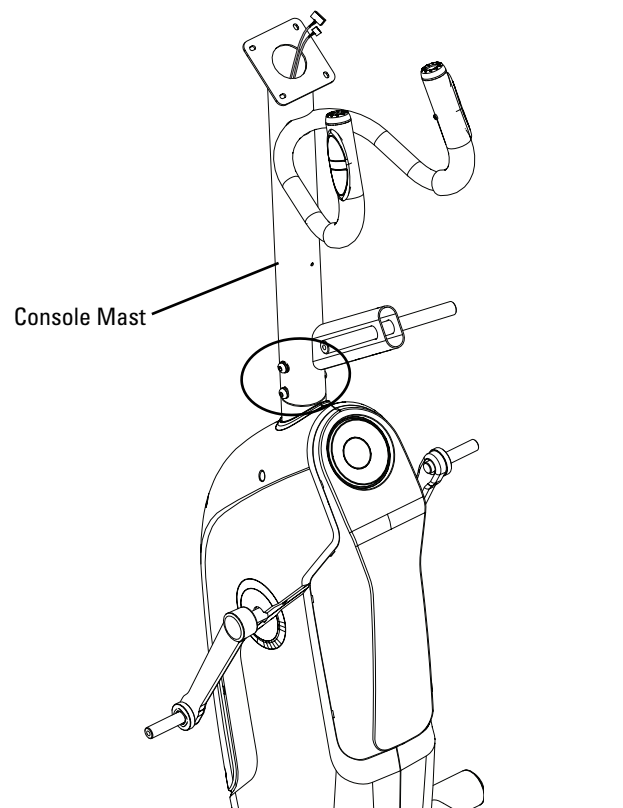

12. With the new Console Mast, connect the Cable from the Frame Assembly and then attach the Console Mast.

Note: Do not crimp the Cables.

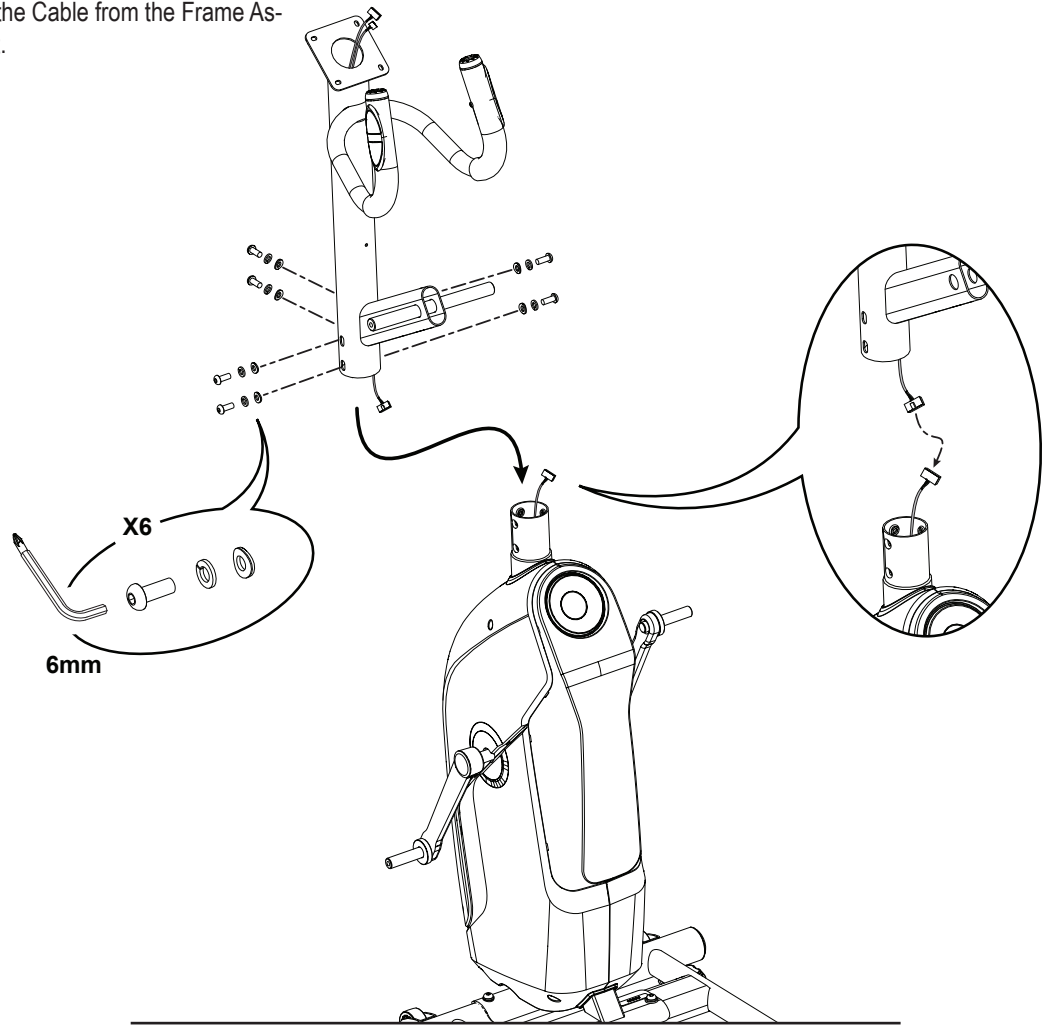

13. Re-assemble the machine in the reverse order of when the parts were removed.

14. Final Inspection

Inspect your machine to ensure that all hardware is tight and components are properly assembled.

⚠ Do not use until the machine has been fully assembled and inspected for correct performance in accordance with the Owner's Manual.

NOTICE: This document provides instructions for the replacement of the Crank Arm on the Schwinn® 411 / 510e Elliptical.

If you need assistance, please contact Customer Service (if purchased in US/Canada) or your local distributor (if purchased outside US/Canada). To find your local distributor, go to: www.nautilusinternational.com

! This icon means a potentially hazardous situation which, if not avoided, could result in death or serious injury. Read and understand all Warnings on this machine.

Nautilus, Inc., www.NautilusInc.com, 5415 Centerpoint Parkway, Groveport, OH 43125 U.S.A. - Customer Service: North America (800) 605-3369, csnls@nautilus.com | outside U.S. www.nautilusinternational.com | Printed in China | © 2018 Nautilus, Inc. | Schwinn and the Schwinn logo are trademarks owned or licensed by Nautilus, Inc., registered or otherwise protected by common law in the United States and other nations. | **ORIGINAL DOCUMENT - ENGLISH VERSION ONLY**

Important Safety Instructions - Before servicing or using this equipment, obey the following warnings:

! This icon means a potentially hazardous situation which, if not avoided, could result in death or serious injury. Read and understand all Warnings on this machine.

- Read and understand the Part Replacement Procedure before working on the machine. Failure to obey the instructions and safety warnings could cause injury to the service technician or bystanders.
- Keep bystanders, children and pets away from the product being serviced at all times.
- Make sure that the repair is done in an appropriate work space away from foot traffic and exposure to bystanders.
- Disconnect all power and allow to sit for 5 minutes before you service this machine.
- Some components of the equipment can be heavy or awkward. Enlist the service of a second person when you do maintenance steps involving these components. Do not try to do heavy or awkward steps on your own.
- If replacement parts are necessary, use only genuine Nautilus replacement parts and hardware. Failure to use genuine replacement parts can cause a risk to users, keep the machine from operating correctly and will void the warranty.
- Be sure that all warning stickers and instructional placards applied to the product stay present and in good condition when doing maintenance or replacing components. If at any time the Warning labels become loose, unreadable or dislodged, replace the labels. If purchased in US/Canada, contact Customer Service for replacement labels. If purchased outside US/Canada, contact your local distributor for them.
- Do not try to change the design or functionality of the machine being serviced as this can adversely effect user safety and will void the warranty.
- Do not use the machine until all shrouds, instructions, warning labels and correct functionality have been verified and tested for correct performance.

Tools Required (not included)

#2 Phillips screwdriver

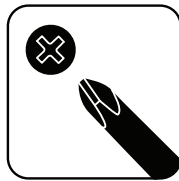

Crank Puller

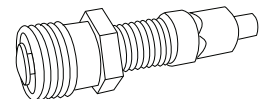

(2) 6mm hex wrenches



14mm socket and wrench



Standard screwdriver



16mm open faced wrench



1. Unplug the AC Adapter from the wall outlet and machine.

2. Using two 6mm hex wrenches, remove the hardware that connects the Pedal Arm to the Lower Handlebars (indicated by arrow).

⚠ Be aware that the Handlebar Assembly will be loose and will pivot when the hardware is removed. Safely allow the Handlebar Assembly to pivot downward and come to rest. Be sure not to be in the path of the Handlebar Assembly.

3. Using a 6mm hex wrench, remove the indicated hardware (by oval) from the Leg and Crank Arm.

4. Carefully slide the Leg / Pedal Assembly off of the Crank Arm and place outside the work area.

5. Repeat the last three Steps on the other side of the machine if replacing the other Crank Arm.

6. Using a small standard screwdriver, gently pry the Cap out of the center of the Crank Cover.

7. Using a 14mm socket and ratchet, remove the Lock Nut (indicated by arrow) from the Crank Arm.



8. Thread the Crank Puller into the Crank Arm. When the Crank Puller is in the correct position, only 1-2 threads on the outer portion (CP2) of the Crank Puller should show.

Note: Be sure the end of the Bolt (CP1) of the Crank Puller is recessed inside of the Nut (CP2) as shown in the photo, before use.

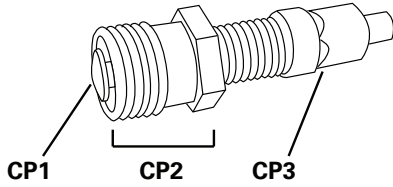

9. Using a wrench, turn the inner portion (CP3) of the Crank Puller clockwise. The Crank Arm will slide off as it is tightened.

Note: Be advised that it may take a lot of force to get the Crank Puller to start to slide off the Crank Arm.

Note: Image does not match your machine.



10. Re-assemble the machine in the reverse order of when the parts were removed.

11. Final Inspection

Inspect your machine to ensure that all hardware is tight and components are properly assembled.

⚠ Do not use until the machine has been fully assembled and inspected for correct performance in accordance with the Owner's Manual.

NOTICE: This document provides instructions for the replacement of the Drive Belt on the Schwinn® 411 / 510e Elliptical.

If you need assistance, please contact Customer Service (if purchased in US/Canada) or your local distributor (if purchased outside US/Canada). To find your local distributor, go to: www.nautilusinternational.com

! This icon means a potentially hazardous situation which, if not avoided, could result in death or serious injury. Read and understand all Warnings on this machine.

Nautilus, Inc., www.NautilusInc.com, 5415 Centerpoint Parkway, Groveport, OH 43125 U.S.A. - Customer Service: North America (800) 605-3369, csnls@nautilus.com | outside U.S. www.nautilusinternational.com | Printed in China | © 2018 Nautilus, Inc. | Schwinn and the Schwinn logo are trademarks owned or licensed by Nautilus, Inc., registered or otherwise protected by common law in the United States and other nations. | **ORIGINAL DOCUMENT - ENGLISH VERSION ONLY**

Important Safety Instructions - Before servicing or using this equipment, obey the following warnings:

! This icon means a potentially hazardous situation which, if not avoided, could result in death or serious injury. Read and understand all Warnings on this machine.

- Read and understand the Part Replacement Procedure before working on the machine. Failure to obey the instructions and safety warnings could cause injury to the service technician or bystanders.
- Keep bystanders, children and pets away from the product being serviced at all times.
- Make sure that the repair is done in an appropriate work space away from foot traffic and exposure to bystanders.
- Disconnect all power and allow to sit for 5 minutes before you service this machine.
- Some components of the equipment can be heavy or awkward. Enlist the service of a second person when you do maintenance steps involving these components. Do not try to do heavy or awkward steps on your own.
- If replacement parts are necessary, use only genuine Nautilus replacement parts and hardware. Failure to use genuine replacement parts can cause a risk to users, keep the machine from operating correctly and will void the warranty.
- Be sure that all warning stickers and instructional placards applied to the product stay present and in good condition when doing maintenance or replacing components. If at any time the Warning labels become loose, unreadable or dislodged, replace the labels. If purchased in US/Canada, contact Customer Service for replacement labels. If purchased outside US/Canada, contact your local distributor for them.
- Do not try to change the design or functionality of the machine being serviced as this can adversely effect user safety and will void the warranty.
- Do not use the machine until all shrouds, instructions, warning labels and correct functionality have been verified and tested for correct performance.

Tools Required (not included)

#2 Phillips screwdriver



Standard screwdriver



(2) 6mm hex wrenches



10mm open faced wrench



1. Unplug the AC Adapter from the wall outlet and machine.

2. Using a standard screwdriver on the small slots along the edge of the Center Engine Shroud, gently pop it off from the Frame Assembly.



3. Using a #2 Phillips screwdriver, remove the indicated screws (by ovals) from the Right Upper Engine Shroud.

Note: To assist with re-assembly, the double oval is a self-tapping screw.



4. Using a #2 Phillips screwdriver, remove the indicated screws (by ovals) from the Left Upper Engine Shroud.

Note: The Power Inlet is attached to the inside of the Left Upper Engine Shroud. Do not crimp the Power Inlet Cable.

5. Remove the Left Upper Engine Shroud.

6. Using a #2 Phillips screwdriver, remove the 4 screws that attach each of the Lower Engine Shrouds, and remove them.

Note: Though shown in the following images, the Shrouds have been removed from the Frame Assembly.

7. Using two 6mm hex wrenches, remove the hardware that connects the Left Pedal Arm to the Lower Handlebars (indicated by arrow).

⚠ Be aware that the Handlebar Assembly will be loose and will pivot when the hardware is removed. Safely allow the Handlebar Assembly to pivot downward and come to rest. Be sure not to be in the path of the Handlebar Assembly.

8. Using a 6mm hex wrench, remove the indicated hardware (by oval) from the Left Leg and Crank Arm.

9. Carefully slide the Left Leg / Pedal Assembly off of the Crank Arm and place outside the work area.



10. Turn the Drive Pulley clockwise while forcing the Drive Belt to the outside to remove it. The belt will come off of the Drive Pulley.

 **Keep fingers out of any pinch hazards when turning the Pulleys.**

11. Remove the old Drive Belt after noting how to properly route the new Drive Belt.

12. Put the new Drive Belt onto the Drive Pulley. Make sure the Drive Belt is aligned on the Flywheel Pulley, Belt Tensioner and Drive Pulley.

13. To test the Drive Belt tension:

- Push the Drive Belt downward at the midpoint between the pulleys and measure the distance. The Drive Belt should have only 0.25" (0.64 cm) of give.

Or:

- Hold the edges of the Drive Belt at the midpoint and twist it. The Drive Belt should turn only 90 degrees (1/4 turn, to vertical).

If the tension is correct, go to Step 18.

If the tension is too loose or too tight, adjust the nut and bolt on the Tensioner Bracket (Idler Assembly).

14. Using a 6mm hex wrench, loosen the Tensioner Hardware.

15. Adjust the Tensioner Nut on the Tensioner Bolt using a 10mm open end wrench.

16. When the tension is correct, tighten the Tensioner Hardware to hold the Tensioner Bracket in position.

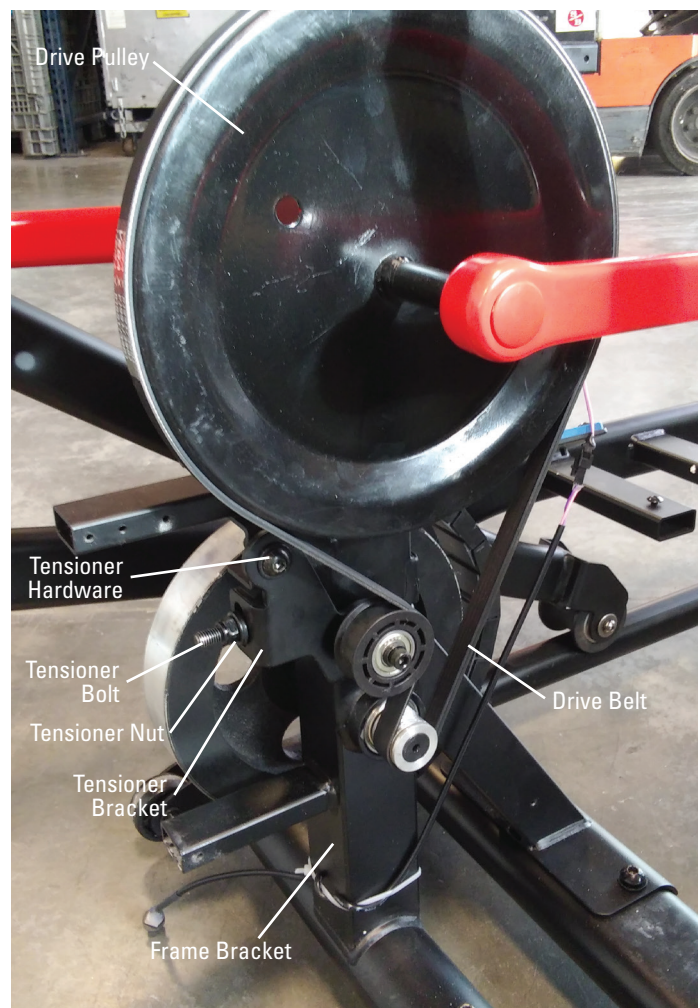
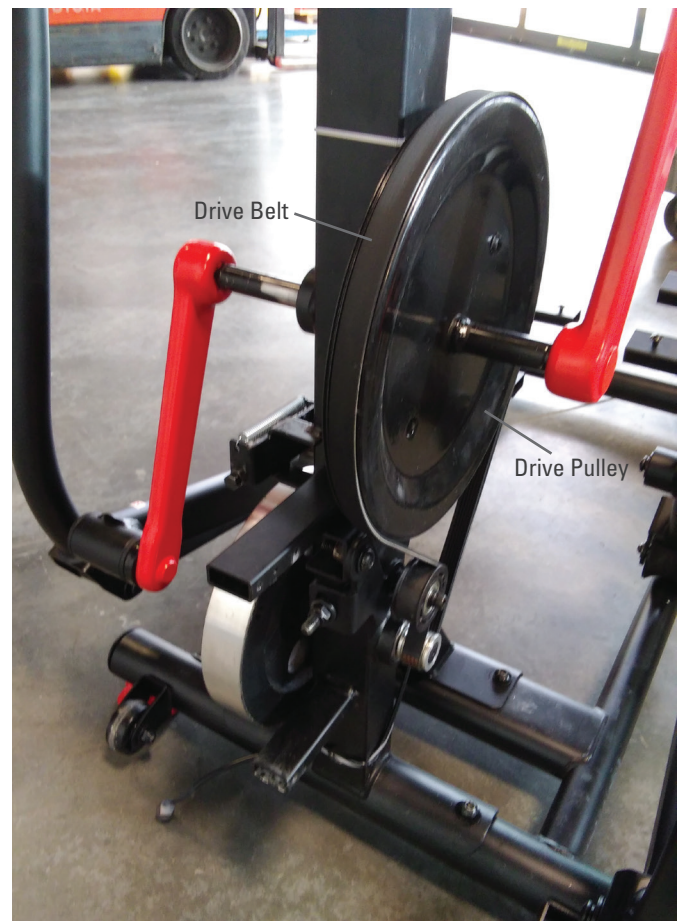

17. Carefully turn the Right Crank Arm and check the movement of the Drive Belt. The Crank Arms and Flywheel should move as one.

 **Be sure to keep fingers clear of all pinch hazards when you turn the Right Crank Arm.**

Adjust the belt tension again if necessary.

18. Re-assemble the machine in the reverse order of when the parts were removed.

19. Final Inspection

Inspect your machine to ensure that all hardware is tight and components are properly assembled.

 **Do not use until the machine has been fully assembled and inspected for correct performance in accordance with the Owner's Manual.**

NOTICE: This document provides instructions for the replacement of the Input/Output (I/O) Cable on the Schwinn® 411 / 510e Elliptical.

If you need assistance, please contact Customer Service (if purchased in US/Canada) or your local distributor (if purchased outside US/Canada). To find your local distributor, go to: www.nautilusinternational.com

 This icon means a potentially hazardous situation which, if not avoided, could result in death or serious injury. Read and understand all Warnings on this machine.

Nautilus, Inc., www.NautilusInc.com, 5415 Centerpoint Parkway, Groveport, OH 43125 U.S.A. - Customer Service: North America (800) 605-3369, csnls@nautilus.com | outside U.S. www.nautilusinternational.com | Printed in China | © 2018 Nautilus, Inc. | Schwinn and the Schwinn logo are trademarks owned or licensed by Nautilus, Inc., registered or otherwise protected by common law in the United States and other nations. | **ORIGINAL DOCUMENT - ENGLISH VERSION ONLY**

Important Safety Instructions - Before servicing or using this equipment, obey the following warnings:

 This icon means a potentially hazardous situation which, if not avoided, could result in death or serious injury. Read and understand all Warnings on this machine.

- Read and understand the Part Replacement Procedure before working on the machine. Failure to obey the instructions and safety warnings could cause injury to the service technician or bystanders.
- Keep bystanders, children and pets away from the product being serviced at all times.
- Make sure that the repair is done in an appropriate work space away from foot traffic and exposure to bystanders.
- Disconnect all power and allow to sit for 5 minutes before you service this machine.
- Some components of the equipment can be heavy or awkward. Enlist the service of a second person when you do maintenance steps involving these components. Do not try to do heavy or awkward steps on your own.
- If replacement parts are necessary, use only genuine Nautilus replacement parts and hardware. Failure to use genuine replacement parts can cause a risk to users, keep the machine from operating correctly and will void the warranty.
- Be sure that all warning stickers and instructional placards applied to the product stay present and in good condition when doing maintenance or replacing components. If at any time the Warning labels become loose, unreadable or dislodged, replace the labels. If purchased in US/Canada, contact Customer Service for replacement labels. If purchased outside US/Canada, contact your local distributor for them.
- Do not try to change the design or functionality of the machine being serviced as this can adversely effect user safety and will void the warranty.
- Do not use the machine until all shrouds, instructions, warning labels and correct functionality have been verified and tested for correct performance.

Tools Required (not included)

#2 Phillips screwdriver



(2) 6mm hex wrenches



5' (152 cm) length of string



1. Unplug the AC Adapter from the wall outlet and machine.

2. Using two 6mm hex wrenches, remove the hardware that connects the Pedal Arms to the Lower Handlebars (indicated by arrow for the right side).

⚠ Be aware that the Handlebar Assembly will be loose and will pivot when the hardware is removed. Safely allow the Handlebar Assembly to pivot downward and come to rest. Be sure not to be in the path of the Handlebar Assembly.

3. Remove the Pivot Shroud from the Frame Assembly.



4. Using a #2 Phillips screwdriver, remove the two screws that secure the Handlebar Shrouds.

5. Remove the Handlebar Shrouds from the Frame Assembly.

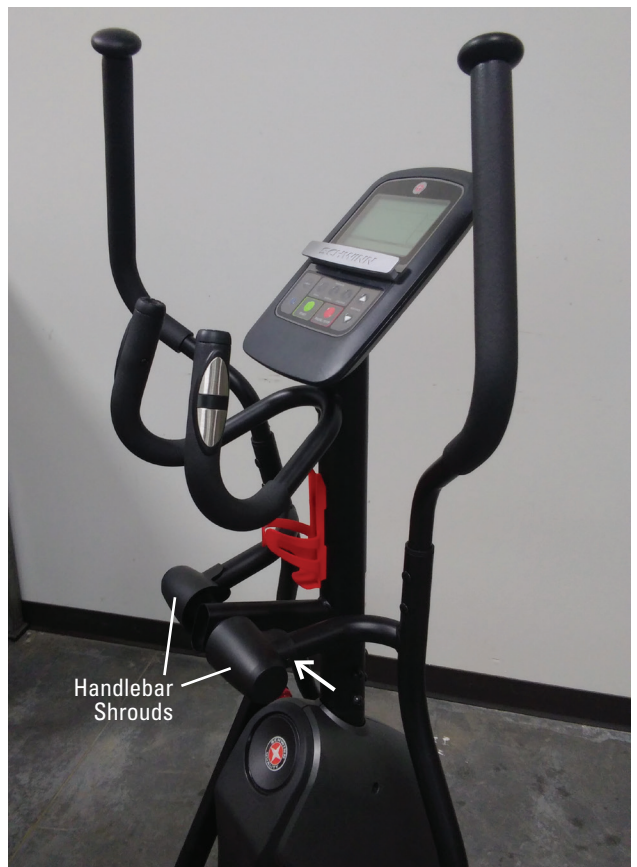

6. Using two 6mm hex wrenches, remove the indicated hardware (by arrows) that attaches the Handlebar Assemblies to the Frame Assembly and Pedal Arms.

⚠ Be aware that the Handlebar Assembly will be loose and will pivot when the hardware is removed. Safely allow the Handlebar Assembly to pivot downward and come to rest. Be sure not to be in the path of the Handlebar Assembly.

7. Carefully remove the Handlebar Assemblies from the Frame Assembly and place outside the work area.



8. Using a 6mm hex wrench, remove the 6 sets of hardware (indicated by oval) from the Console Mast.

9. Slightly lift the Console Mast from the Frame Assembly and disconnect the Cables. Fully remove the Console Mast with the Cables.

Note: Do not crimp the Cables. Do not allow the Cables to be pulled into the Console Mast.

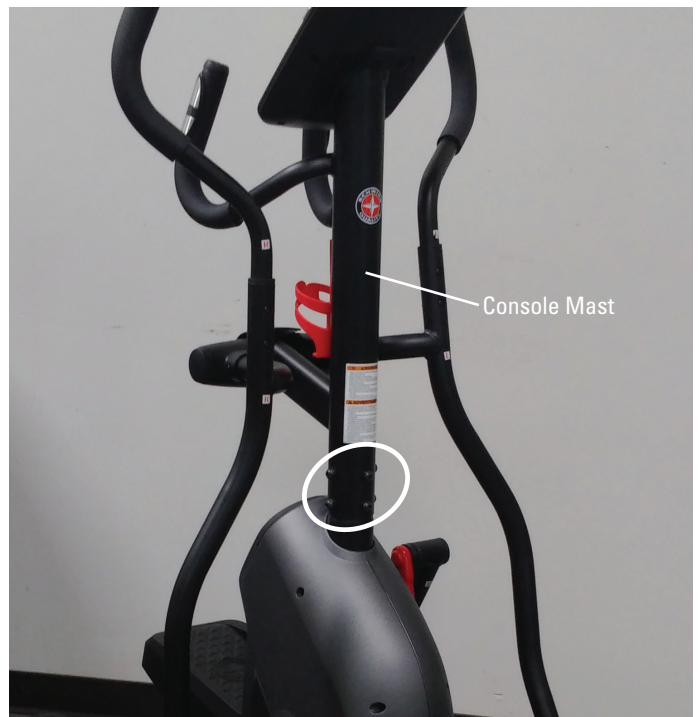

10. Using a #2 Phillips screwdriver, remove the four screws (indicated by arrows) that attach the Console to the Console Mast.

11. Slightly lift the Console from the Console Mast and disconnect the Cables from the back of the Console.

Note: Do not crimp the Cables.

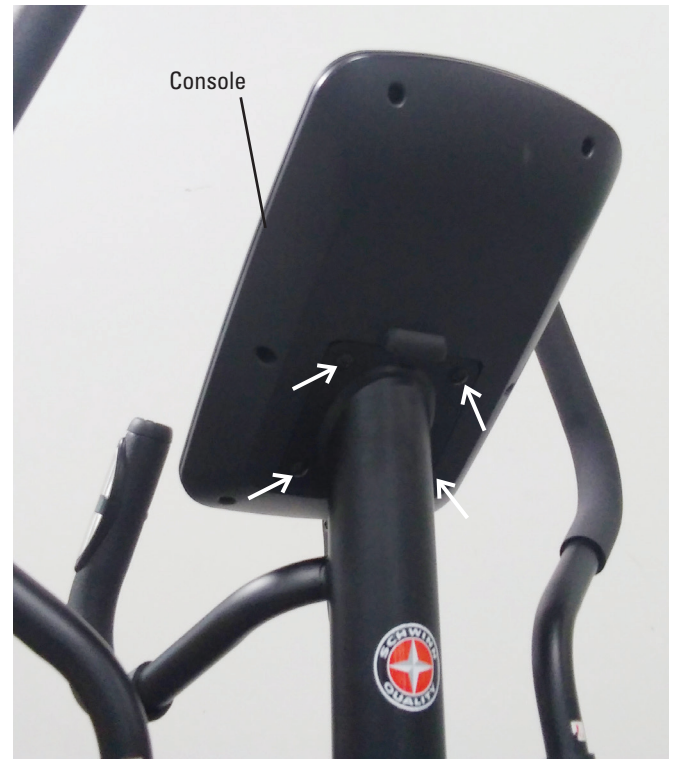

12. Tie a piece of string or wire to the end of the old I/O Cable where it attached to the Console.

13. Slightly lift the Console Mast from the Frame Assembly and disconnect the Cables. Fully remove the Console Mast with the Cables.

Note: Do not crimp the Cables. Do not allow the Cables to be pulled into the Console Mast.

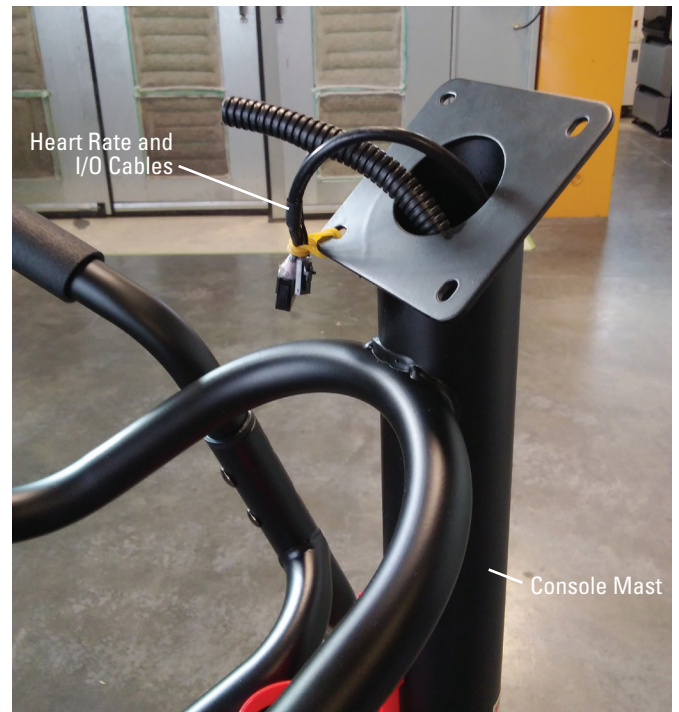

14. Hold the lower end of the old I/O Cable and carefully pull it down through the Console Mast. Untie the string from the old I/O Cable and discard the old I/O Cable.

15. Connect the new I/O Cable to the piece of string or wire.

Note: Do not crimp the Cables.

16. Hold the upper end of the string and carefully pull the new I/O Cable through the Console Mast.

Note: Do not crimp the cables.

17. With the new I/O Cable routed through the Console Mast, reconnect the Cables to the Frame Assembly, and then re-attach the Console Mast without crimping the Cables.

18. Untie the string from the new I/O Cable.

Note: Do not crimp the Cables.

19. Connect the new I/O Cable and HR Cable to the Console, and attach it to the Console Mast.

Note: Do not crimp the Cables.

20. Re-assemble the machine in the reverse order of when the parts were removed.

21. Final Inspection

Inspect your machine to ensure that all hardware is tight and components are properly assembled.



Do not use until the machine has been fully assembled and inspected for correct performance in accordance with the Owner's Manual.

NOTICE: This document provides instructions for the replacement of the Pedals and Legs on the Schwinn® 411 / 510e Elliptical.

If you need assistance, please contact Customer Service (if purchased in US/Canada) or your local distributor (if purchased outside US/Canada). To find your local distributor, go to: www.nautilusinternational.com

 This icon means a potentially hazardous situation which, if not avoided, could result in death or serious injury. Read and understand all Warnings on this machine.

Nautilus, Inc., www.NautilusInc.com, 5415 Centerpoint Parkway, Groveport, OH 43125 U.S.A. - Customer Service: North America (800) 605-3369, csnls@nautilus.com | outside U.S. www.nautilusinternational.com | Printed in China | © 2018 Nautilus, Inc. | Schwinn and the Schwinn logo are trademarks owned or licensed by Nautilus, Inc., registered or otherwise protected by common law in the United States and other nations. | **ORIGINAL DOCUMENT - ENGLISH VERSION ONLY**

Important Safety Instructions - Before servicing or using this equipment, obey the following warnings:

 This icon means a potentially hazardous situation which, if not avoided, could result in death or serious injury. Read and understand all Warnings on this machine.

- Read and understand the Part Replacement Procedure before working on the machine. Failure to obey the instructions and safety warnings could cause injury to the service technician or bystanders.
- Keep bystanders, children and pets away from the product being serviced at all times.
- Make sure that the repair is done in an appropriate work space away from foot traffic and exposure to bystanders.
- Disconnect all power and allow to sit for 5 minutes before you service this machine.
- Some components of the equipment can be heavy or awkward. Enlist the service of a second person when you do maintenance steps involving these components. Do not try to do heavy or awkward steps on your own.
- If replacement parts are necessary, use only genuine Nautilus replacement parts and hardware. Failure to use genuine replacement parts can cause a risk to users, keep the machine from operating correctly and will void the warranty.
- Be sure that all warning stickers and instructional placards applied to the product stay present and in good condition when doing maintenance or replacing components. If at any time the Warning labels become loose, unreadable or dislodged, replace the labels. If purchased in US/Canada, contact Customer Service for replacement labels. If purchased outside US/Canada, contact your local distributor for them.
- Do not try to change the design or functionality of the machine being serviced as this can adversely effect user safety and will void the warranty.
- Do not use the machine until all shrouds, instructions, warning labels and correct functionality have been verified and tested for correct performance.

Tools Required (not included)

#2 Phillips screwdriver



(2) 6mm hex wrenches



1. Unplug the AC Adapter from the wall outlet and machine.

2. Using two 6mm hex wrenches, remove the hardware that connects the Pedal Arms to the Handlebar Assembly (indicated by arrow for the right side).

⚠ Be aware that the Handlebar Assembly will be loose and will pivot when the hardware is removed. Safely allow the Handlebar Assembly to pivot downward and come to rest. Be sure not to be in the path of the Handlebar Assembly.

3. Using a 6mm hex wrench, remove the indicated hardware (by arrows) from the Leg and Pedal Arm.



4. Remove the old Leg and Pedal Arm from the Frame Assembly.

Note: Be sure to observe the proper orientation of the Leg to assist with re-assembly.

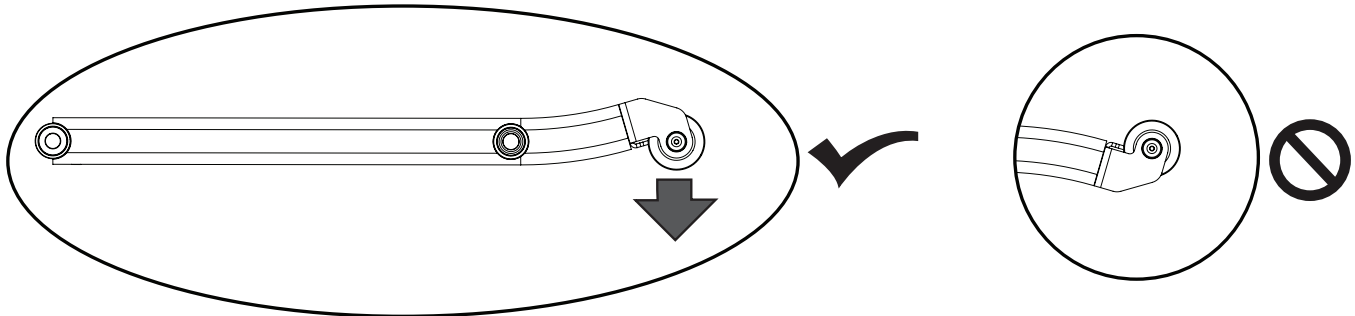

5. If replacing the Pedal Arm, remove the Foot Pad Insert from the Pedal.

6. Using a #2 Phillips screwdriver, remove the 5 screws that attach the Foot Pad to the Pedal Arm.

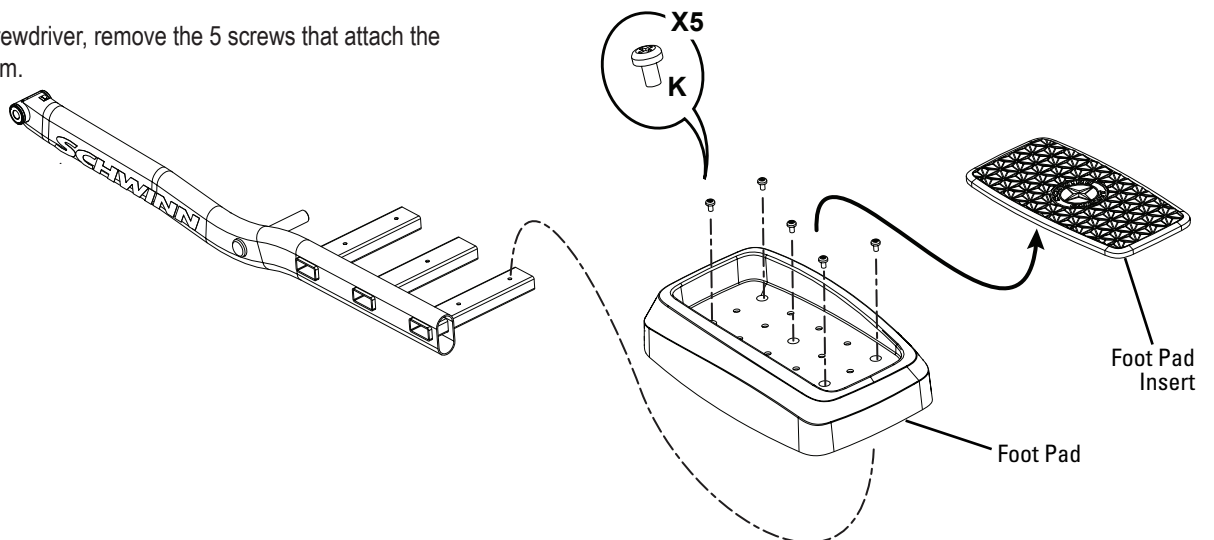

7. Remove the old Leg and/or Pedal Arm and replace with the new Leg and/or Pedal Arm.

8. Re-assemble the machine in the reverse order of when the parts were removed.

9. Final Inspection

Inspect your machine to ensure that all hardware is tight and components are properly assembled.



Do not use until the machine has been fully assembled and inspected for correct performance in accordance with the Owner's Manual.

NOTICE: This document provides instructions for the replacement of the Power Inlet on the Schwinn® 411 / 510e Elliptical.

If you need assistance, please contact Customer Service (if purchased in US/Canada) or your local distributor (if purchased outside US/Canada). To find your local distributor, go to: www.nautilusinternational.com

! This icon means a potentially hazardous situation which, if not avoided, could result in death or serious injury. Read and understand all Warnings on this machine.

Nautilus, Inc., www.NautilusInc.com, 5415 Centerpoint Parkway, Groveport, OH 43125 U.S.A. - Customer Service: North America (800) 605-3369, csnls@nautilus.com | outside U.S. www.nautilusinternational.com | Printed in China | © 2018 Nautilus, Inc. | Schwinn and the Schwinn logo are trademarks owned or licensed by Nautilus, Inc., registered or otherwise protected by common law in the United States and other nations. | **ORIGINAL DOCUMENT - ENGLISH VERSION ONLY**

Important Safety Instructions - Before servicing or using this equipment, obey the following warnings:

! This icon means a potentially hazardous situation which, if not avoided, could result in death or serious injury. Read and understand all Warnings on this machine.

- Read and understand the Part Replacement Procedure before working on the machine. Failure to obey the instructions and safety warnings could cause injury to the service technician or bystanders.
- Keep bystanders, children and pets away from the product being serviced at all times.
- Make sure that the repair is done in an appropriate work space away from foot traffic and exposure to bystanders.
- Disconnect all power and allow to sit for 5 minutes before you service this machine.
- Some components of the equipment can be heavy or awkward. Enlist the service of a second person when you do maintenance steps involving these components. Do not try to do heavy or awkward steps on your own.
- If replacement parts are necessary, use only genuine Nautilus replacement parts and hardware. Failure to use genuine replacement parts can cause a risk to users, keep the machine from operating correctly and will void the warranty.
- Be sure that all warning stickers and instructional placards applied to the product stay present and in good condition when doing maintenance or replacing components. If at any time the Warning labels become loose, unreadable or dislodged, replace the labels. If purchased in US/Canada, contact Customer Service for replacement labels. If purchased outside US/Canada, contact your local distributor for them.
- Do not try to change the design or functionality of the machine being serviced as this can adversely effect user safety and will void the warranty.
- Do not use the machine until all shrouds, instructions, warning labels and correct functionality have been verified and tested for correct performance.

Tools Required (not included)

#2 Phillips screwdriver



Standard screwdriver



14mm open faced wrench



1. Unplug the AC Adapter from the wall outlet and machine.

2. Using a standard screwdriver on the small slots along the edge of the Center Engine Shroud, gently pop it off from the Frame Assembly.



3. Using a #2 Phillips screwdriver, remove the indicated screws (by ovals) from the Right Upper Engine Shroud.

Note: To assist with re-assembly, the double oval is a self-tapping screw.



4. Using a #2 Phillips screwdriver, remove the indicated screws (by ovals) from the Left Upper Engine Shroud.

Note: The Power Inlet is attached to the inside of the Left Upper Engine Shroud. Do not crimp the Power Inlet Cable.



5. Using a 14mm wrench, loosen and remove the thin Nut from the Power Inlet Assembly on the Left Upper Engine Shroud.

Note: Do not crimp the Cable.

6. Remove the old Power Inlet Assembly, and replace with the new Power Inlet Assembly.

Note: Do not crimp the Cables.

7. Re-assemble the machine in the reverse order of when the parts were removed.

8. Final Inspection

Inspect your machine to ensure that all hardware is tight and components are properly assembled.

⚠ Do not use until the machine has been fully assembled and inspected for correct performance in accordance with the Owner's Manual.



NOTICE: This document provides instructions for the replacement of the Rail Assembly on the Schwinn® 411 / 510e Elliptical.

If you need assistance, please contact Customer Service (if purchased in US/Canada) or your local distributor (if purchased outside US/Canada). To find your local distributor, go to: www.nautilusinternational.com

! This icon means a potentially hazardous situation which, if not avoided, could result in death or serious injury. Read and understand all Warnings on this machine.

Nautilus, Inc., www.NautilusInc.com, 5415 Centerpoint Parkway, Groveport, OH 43125 U.S.A. - Customer Service: North America (800) 605-3369, csnls@nautilus.com | outside U.S. www.nautilusinternational.com | Printed in China | © 2018 Nautilus, Inc. | Schwinn and the Schwinn logo are trademarks owned or licensed by Nautilus, Inc., registered or otherwise protected by common law in the United States and other nations. | **ORIGINAL DOCUMENT - ENGLISH VERSION ONLY**

Important Safety Instructions - Before servicing or using this equipment, obey the following warnings:

! This icon means a potentially hazardous situation which, if not avoided, could result in death or serious injury. Read and understand all Warnings on this machine.

- Read and understand the Part Replacement Procedure before working on the machine. Failure to obey the instructions and safety warnings could cause injury to the service technician or bystanders.
- Keep bystanders, children and pets away from the product being serviced at all times.
- Make sure that the repair is done in an appropriate work space away from foot traffic and exposure to bystanders.
- Disconnect all power and allow to sit for 5 minutes before you service this machine.
- Some components of the equipment can be heavy or awkward. Enlist the service of a second person when you do maintenance steps involving these components. Do not try to do heavy or awkward steps on your own.
- If replacement parts are necessary, use only genuine Nautilus replacement parts and hardware. Failure to use genuine replacement parts can cause a risk to users, keep the machine from operating correctly and will void the warranty.
- Be sure that all warning stickers and instructional placards applied to the product stay present and in good condition when doing maintenance or replacing components. If at any time the Warning labels become loose, unreadable or dislodged, replace the labels. If purchased in US/Canada, contact Customer Service for replacement labels. If purchased outside US/Canada, contact your local distributor for them.
- Do not try to change the design or functionality of the machine being serviced as this can adversely effect user safety and will void the warranty.
- Do not use the machine until all shrouds, instructions, warning labels and correct functionality have been verified and tested for correct performance.

Tools Required (not included)

#2 Phillips screwdriver



(2) 6mm hex wrenches



1. Unplug the AC Adapter from the wall outlet and machine.

2. Remove the Pivot Shroud from the Frame Assembly.



3. Using a #2 Phillips screwdriver, remove the two screws that secure the Handlebar Shrouds.

4. Remove the Handlebar Shrouds from the Frame Assembly.



5. Using two 6mm hex wrenches, remove the indicated hardware (by arrows) that attaches the Handlebar Assemblies to the Frame Assembly and Pedal Arms.

⚠ Be aware that the Handlebar Assembly will be loose and will pivot when the hardware is removed. Safely allow the Handlebar Assembly to pivot downward and come to rest. Be sure not to be in the path of the Handlebar Assembly.

6. Carefully remove the Handlebar Assemblies from the Frame Assembly and place outside the work area.

7. Using a 6mm hex wrench, remove the indicated hardware (by an oval) from the Leg and Crank Arm.

8. Remove the Leg and Pedal Arm Assembly from the Frame Assembly.



! A second person is recommended to stabilize the Frame Assembly.

9. Using a 6mm hex wrench, remove the indicated hardware from the Frame Assembly. Be prepared to support the Frame Assembly before removing the hardware.

! The Frame Assembly may be awkward when released from the Rail Assembly. Some components of the machine can be heavy or awkward. Use a second person to hold the Frame Assembly stable and upright. Do not do steps that involve heavy lifting or awkward movements on your own.

10. With the assistance of a second person, carefully lift the Frame Assembly from the old Rail Assembly and place onto the new Rail Assembly.

! Be sure not to allow your fingers or hands to be pinched, or damage to be caused to the floor.

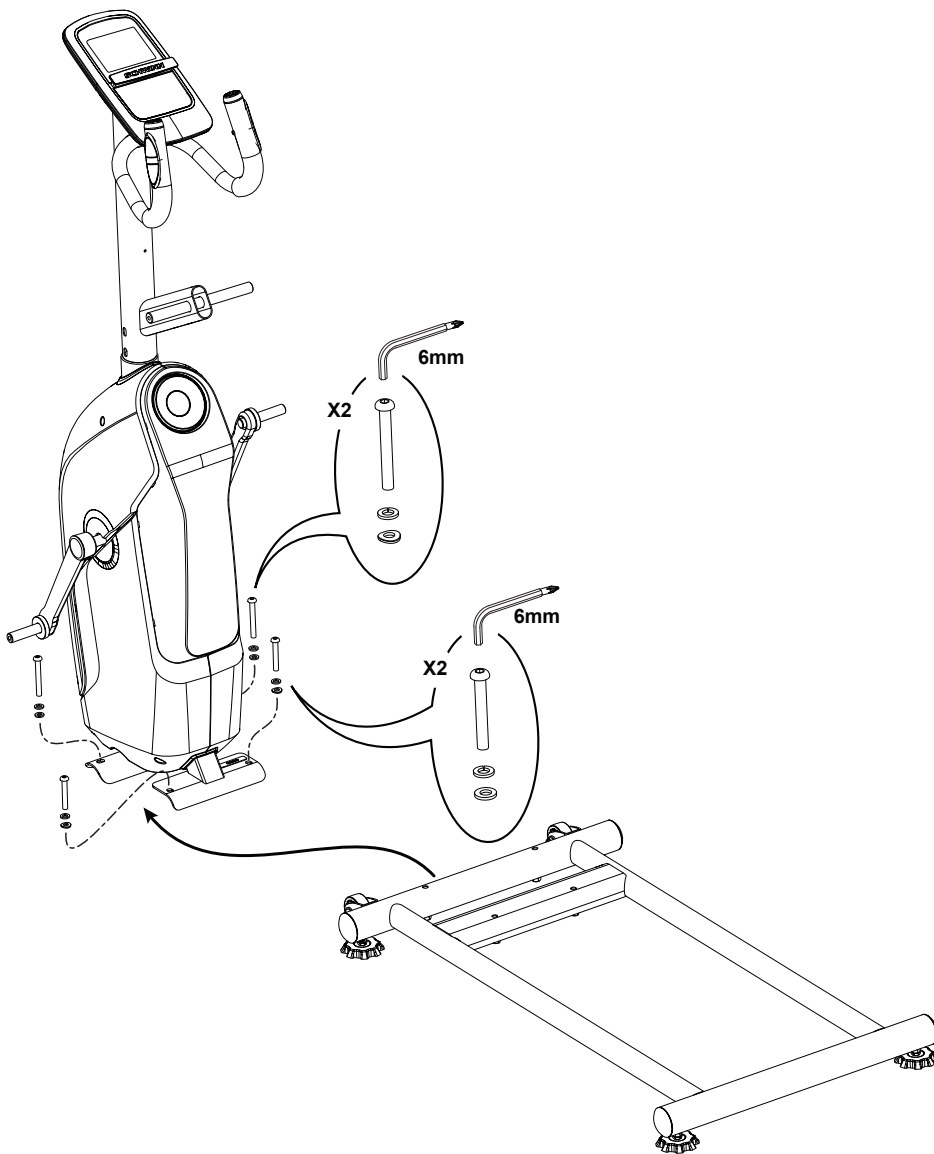

11. Re-assemble the machine in the reverse order of when the parts were removed.

12. Final Inspection

Inspect your machine to ensure that all hardware is tight and components are properly assembled.

! Do not use until the machine has been fully assembled and inspected for correct performance in accordance with the Owner's Manual.

NOTICE: This document provides instructions for the replacement of the Servo Motor on the Schwinn® 411 / 510e Elliptical.

If you need assistance, please contact Customer Service (if purchased in US/Canada) or your local distributor (if purchased outside US/Canada). To find your local distributor, go to: www.nautilusinternational.com

! This icon means a potentially hazardous situation which, if not avoided, could result in death or serious injury. Read and understand all Warnings on this machine.

Nautilus, Inc., www.NautilusInc.com, 5415 Centerpoint Parkway, Groveport, OH 43125 U.S.A. - Customer Service: North America (800) 605-3369, csnls@nautilus.com | outside U.S. www.nautilusinternational.com | Printed in China | © 2018 Nautilus, Inc. | Schwinn and the Schwinn logo are trademarks owned or licensed by Nautilus, Inc., registered or otherwise protected by common law in the United States and other nations. | **ORIGINAL DOCUMENT - ENGLISH VERSION ONLY**

Important Safety Instructions - Before servicing or using this equipment, obey the following warnings:

! This icon means a potentially hazardous situation which, if not avoided, could result in death or serious injury. Read and understand all Warnings on this machine.

- Read and understand the Part Replacement Procedure before working on the machine. Failure to obey the instructions and safety warnings could cause injury to the service technician or bystanders.
- Keep bystanders, children and pets away from the product being serviced at all times.
- Make sure that the repair is done in an appropriate work space away from foot traffic and exposure to bystanders.
- Disconnect all power and allow to sit for 5 minutes before you service this machine.
- Some components of the equipment can be heavy or awkward. Enlist the service of a second person when you do maintenance steps involving these components. Do not try to do heavy or awkward steps on your own.
- If replacement parts are necessary, use only genuine Nautilus replacement parts and hardware. Failure to use genuine replacement parts can cause a risk to users, keep the machine from operating correctly and will void the warranty.
- Be sure that all warning stickers and instructional placards applied to the product stay present and in good condition when doing maintenance or replacing components. If at any time the Warning labels become loose, unreadable or dislodged, replace the labels. If purchased in US/Canada, contact Customer Service for replacement labels. If purchased outside US/Canada, contact your local distributor for them.
- Do not try to change the design or functionality of the machine being serviced as this can adversely effect user safety and will void the warranty.
- Do not use the machine until all shrouds, instructions, warning labels and correct functionality have been verified and tested for correct performance.

Tools Required (not included)

#2 Phillips screwdriver



(2) 8mm open faced wrenches



(2) 6mm hex wrenches



Standard screwdriver

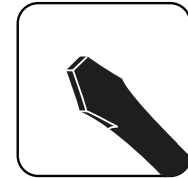

5' (152 cm) length of string

2.5" x 10" cardboard and tape

Replacement Zip Tie



1. Unplug the AC Adapter from the wall outlet and machine.

2. Remove the Pivot Shroud from the Frame Assembly.



3. Using a #2 Phillips screwdriver, remove the two screws that secure the Handlebar Shrouds.

4. Remove the Handlebar Shrouds from the Frame Assembly.



5. Using two 6mm hex wrenches, remove the indicated hardware (by arrows) that attaches the Handlebar Assemblies to the Frame Assembly and Pedal Arms.

⚠ Be aware that the Handlebar Assembly will be loose and will pivot when the hardware is removed. Safely allow the Handlebar Assembly to pivot downward and come to rest. Be sure not to be in the path of the Handlebar Assembly.

6. Carefully remove the Handlebar Assemblies from the Frame Assembly and place outside the work area.



7. Using a 6mm hex wrench, remove the 6 sets of hardware (indicated by oval) from the Console Mast.

8. Slightly lift the Console Mast from the Frame Assembly and disconnect the Cables. Fully remove the Console Mast with the Cables.

Note: Do not crimp the Cables. Do not allow the Cables to be pulled into the Console Mast.

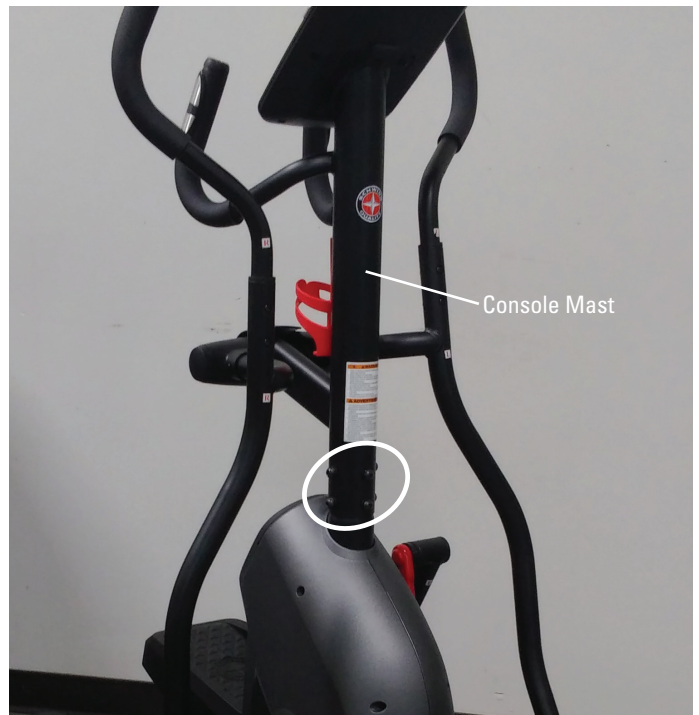

9. Using a standard screwdriver on the small slots along the edge of the Center Engine Shroud, gently pop it off from the Frame Assembly.



10. Using a #2 Phillips screwdriver, remove the indicated screws (by ovals) from the Right Upper Engine Shroud.

Note: To assist with re-assembly, the double oval is a self-tapping screw.



11. Using a #2 Phillips screwdriver, remove the indicated screws (by ovals) from the Left Upper Engine Shroud.

Note: The Power Inlet is attached to the inside of the Left Upper Engine Shroud. Do not crimp the Power Inlet Cable.

12. Remove the Left Upper Engine Shroud.

13. Using a #2 Phillips screwdriver, remove the 4 screws that attach each of the Lower Engine Shrouds, and remove them.



14. Disconnect the Speed Sensor and Power Input Cables from the Servo Motor. Connectors are indicated by ovals.

Note: Do not crimp the Cables.

15. Insert 2.5" x 10" cardboard between the Brake Magnet and the Flywheel, and tape the cardboard to the Brake Magnet.

Note: Be sure the cardboard covers all of the Brake Magnet. The cardboard will keep the Brake Magnet from grabbing onto the Flywheel.

16. Using a #2 Phillips screwdriver, remove the two screws that attach the Servo Motor Bracket to the Servo Motor.

17. Using two 8mm open faced wrenches, loosen both of the securing nuts that secure the Brake Cable to the Brake Arm.

18. Push the Brake Arm toward the Servo Motor and slide the Brake Cable out of the Brake Arm.

19. Using a #2 Phillips screwdriver, remove the four screws that attach the Servo Motor to the Frame Assembly.

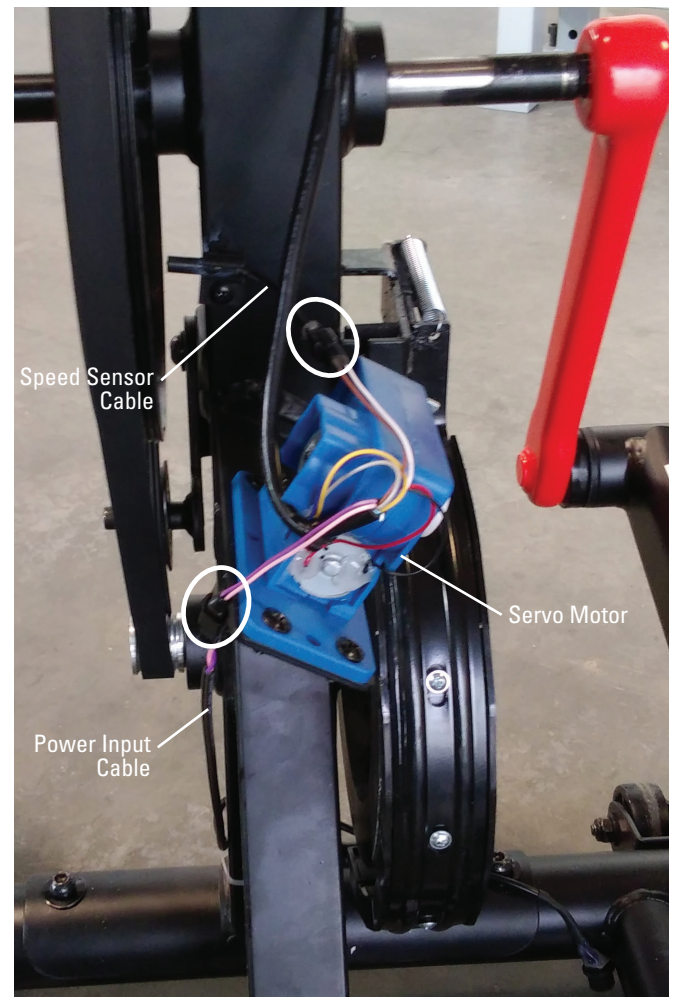

20. Cut the Zip-Tie that secures the Servo Motor Cable to the Frame Assembly.

21. Tie a piece of string or wire to the end of the old Servo Motor Cable where it attached to the I/O Cable from the Console Mast.

22. Grasp the lower end of the old Servo Motor Cable and carefully pull it down through the Frame Assembly. Untie the string from the old Servo Motor Cable.

23. Using a #2 Phillips screwdriver, remove the four screws that attach the Servo Motor to the Frame Assembly.

24. Replace the old Servo Motor with the new Servo Motor.

25. Connect the new Servo Motor Cable to the piece of string or wire through the Frame Assembly.

Note: Do not crimp the Cable.

26. Hold the upper end of the string and carefully pull the new Servo Motor Cable through the Frame Assembly.

Note: Do not crimp the cables.

27. Untie the string from the new Servo Motor Cable.

Note: Do not crimp the Cable.

28. Connect the Servo Motor Cable to the Console Mast Cable, and attach the Console Mast.

Note: Do not crimp the Cable.

29. Re-assemble the machine in the reverse order of when the parts were removed.

30. Final Inspection

Inspect your machine to ensure that all hardware is tight and components are properly assembled.

! Do not use until the machine has been fully assembled and inspected for correct performance in accordance with the Owner's Manual.

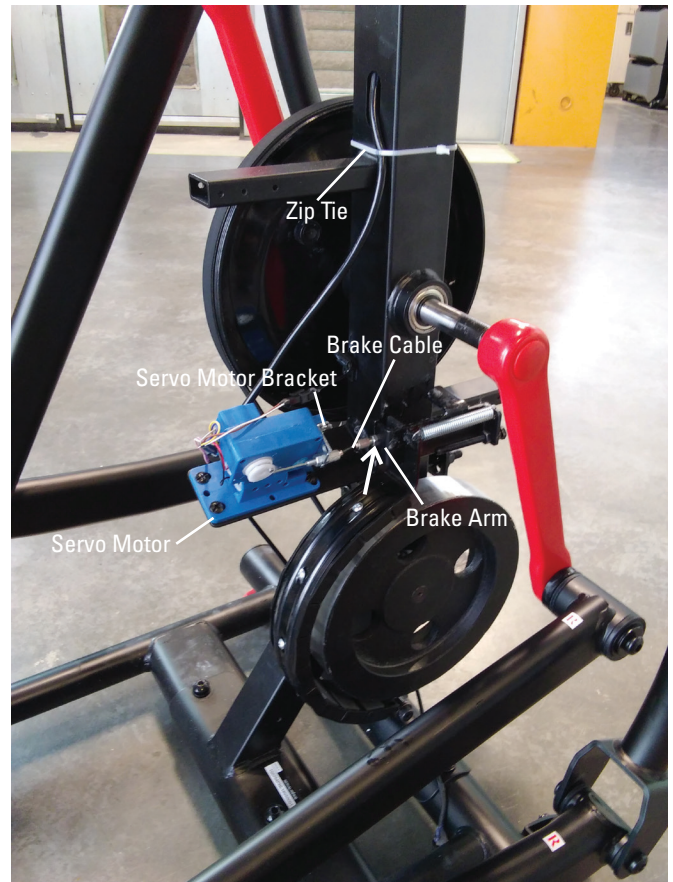

NOTICE: This document provides instructions for the replacement of the Shrouds on the Schwinn® 411 / 510e Elliptical.

If you need assistance, please contact Customer Service (if purchased in US/Canada) or your local distributor (if purchased outside US/Canada). To find your local distributor, go to: www.nautilusinternational.com

! This icon means a potentially hazardous situation which, if not avoided, could result in death or serious injury. Read and understand all Warnings on this machine.

Nautilus, Inc., www.NautilusInc.com, 5415 Centerpoint Parkway, Groveport, OH 43125 U.S.A. - Customer Service: North America (800) 605-3369, csnls@nautilus.com | outside U.S. www.nautilusinternational.com | Printed in China | © 2018 Nautilus, Inc. | Schwinn and the Schwinn logo are trademarks owned or licensed by Nautilus, Inc., registered or otherwise protected by common law in the United States and other nations. | **ORIGINAL DOCUMENT - ENGLISH VERSION ONLY**

Important Safety Instructions - Before servicing or using this equipment, obey the following warnings:

! This icon means a potentially hazardous situation which, if not avoided, could result in death or serious injury. Read and understand all Warnings on this machine.

- Read and understand the Part Replacement Procedure before working on the machine. Failure to obey the instructions and safety warnings could cause injury to the service technician or bystanders.
- Keep bystanders, children and pets away from the product being serviced at all times.
- Make sure that the repair is done in an appropriate work space away from foot traffic and exposure to bystanders.
- Disconnect all power and allow to sit for 5 minutes before you service this machine.
- Some components of the equipment can be heavy or awkward. Enlist the service of a second person when you do maintenance steps involving these components. Do not try to do heavy or awkward steps on your own.
- If replacement parts are necessary, use only genuine Nautilus replacement parts and hardware. Failure to use genuine replacement parts can cause a risk to users, keep the machine from operating correctly and will void the warranty.
- Be sure that all warning stickers and instructional placards applied to the product stay present and in good condition when doing maintenance or replacing components. If at any time the Warning labels become loose, unreadable or dislodged, replace the labels. If purchased in US/Canada, contact Customer Service for replacement labels. If purchased outside US/Canada, contact your local distributor for them.
- Do not try to change the design or functionality of the machine being serviced as this can adversely effect user safety and will void the warranty.
- Do not use the machine until all shrouds, instructions, warning labels and correct functionality have been verified and tested for correct performance.

Tools Required (not included)

#2 Phillips screwdriver



Standard screwdriver



1. Unplug the AC Adapter from the wall outlet and machine.

2. Using a standard screwdriver on the small slots along the edge of the Center Engine Shroud, gently pop it off from the Frame Assembly.



3. Using a #2 Phillips screwdriver, remove the indicated screws (by ovals) from the Right Upper Engine Shroud.

Note: To assist with re-assembly, the double oval is a self-tapping screw.



4. Using a #2 Phillips screwdriver, remove the indicated screws (by ovals) from the Left Upper Engine Shroud.

Note: The Power Inlet is attached to the inside of the Left Upper Engine Shroud. Do not crimp the Power Inlet Cable.

5. Remove the Left Upper Engine Shroud.

6. Using a #2 Phillips screwdriver, remove the 4 screws that attach each of the Lower Engine Shrouds, and remove them.



7. Re-assemble the machine in the reverse order of when the parts were removed.

8. Final Inspection

Inspect your machine to ensure that all hardware is tight and components are properly assembled.

⚠ Do not use until the machine has been fully assembled and inspected for correct performance in accordance with the Owner's Manual.



NOTICE: This document provides instructions for the replacement of the Speed Sensor on the Schwinn® 411 / 510e Elliptical.

If you need assistance, please contact Customer Service (if purchased in US/Canada) or your local distributor (if purchased outside US/Canada). To find your local distributor, go to: www.nautilusinternational.com

! This icon means a potentially hazardous situation which, if not avoided, could result in death or serious injury. Read and understand all Warnings on this machine.

Nautilus, Inc., www.NautilusInc.com, 5415 Centerpoint Parkway, Groveport, OH 43125 U.S.A. - Customer Service: North America (800) 605-3369, csnls@nautilus.com | outside U.S. www.nautilusinternational.com | Printed in China | © 2018 Nautilus, Inc. | Schwinn and the Schwinn logo are trademarks owned or licensed by Nautilus, Inc., registered or otherwise protected by common law in the United States and other nations. | **ORIGINAL DOCUMENT - ENGLISH VERSION ONLY**

Important Safety Instructions - Before servicing or using this equipment, obey the following warnings:

! This icon means a potentially hazardous situation which, if not avoided, could result in death or serious injury. Read and understand all Warnings on this machine.

- Read and understand the Part Replacement Procedure before working on the machine. Failure to obey the instructions and safety warnings could cause injury to the service technician or bystanders.
- Keep bystanders, children and pets away from the product being serviced at all times.
- Make sure that the repair is done in an appropriate work space away from foot traffic and exposure to bystanders.
- Disconnect all power and allow to sit for 5 minutes before you service this machine.
- Some components of the equipment can be heavy or awkward. Enlist the service of a second person when you do maintenance steps involving these components. Do not try to do heavy or awkward steps on your own.
- If replacement parts are necessary, use only genuine Nautilus replacement parts and hardware. Failure to use genuine replacement parts can cause a risk to users, keep the machine from operating correctly and will void the warranty.
- Be sure that all warning stickers and instructional placards applied to the product stay present and in good condition when doing maintenance or replacing components. If at any time the Warning labels become loose, unreadable or dislodged, replace the labels. If purchased in US/Canada, contact Customer Service for replacement labels. If purchased outside US/Canada, contact your local distributor for them.
- Do not try to change the design or functionality of the machine being serviced as this can adversely effect user safety and will void the warranty.
- Do not use the machine until all shrouds, instructions, warning labels and correct functionality have been verified and tested for correct performance.

Tools Required (not included)

#2 Phillips screwdriver



Standard screwdriver



1. Unplug the AC Adapter from the wall outlet and machine.

2. Using a standard screwdriver on the small slots along the edge of the Center Engine Shroud, gently pop it off from the Frame Assembly.



Note: Shrouds have been removed from the following images for clarity.

3. Disconnect the Speed Sensor Cable from the Servo Motor. The connection is indicated by an oval.

Note: Do not crimp the Cables.

4. Using a #2 Phillips screwdriver, remove the indicated screws (by arrows) from the Speed Sensor.

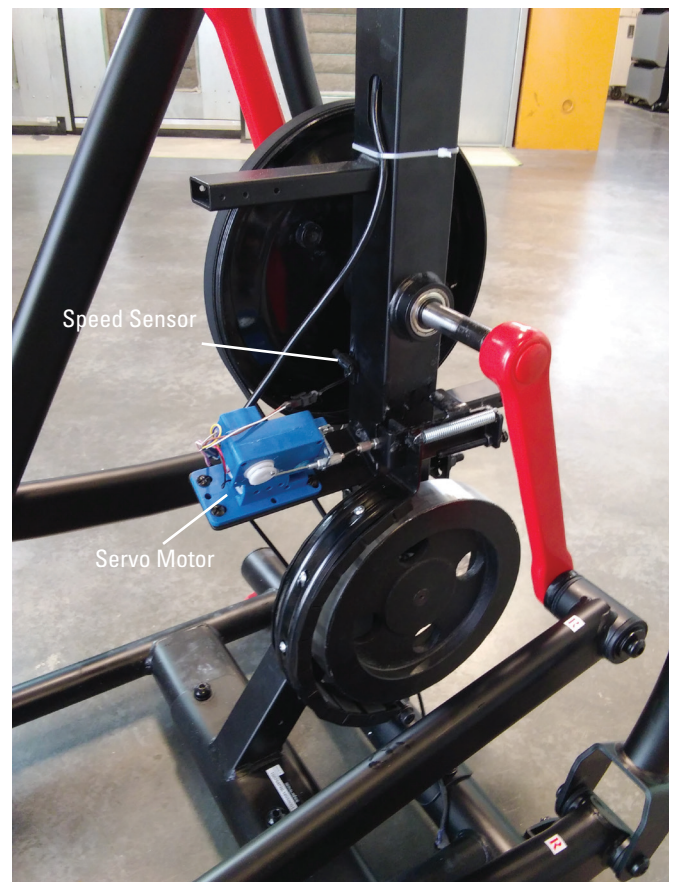
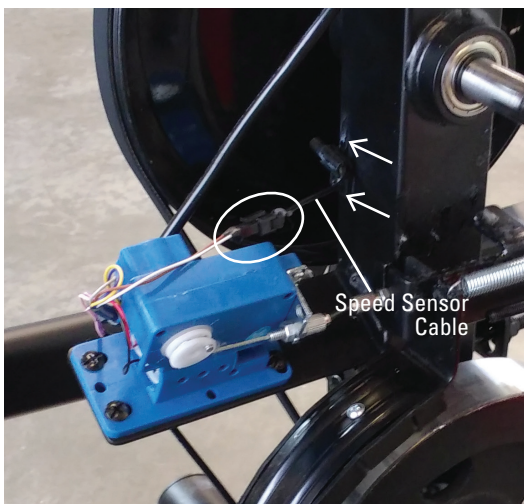

5. Remove the old Speed Sensor and replace with the new Speed Sensor.

6. Re-assemble the machine in the reverse order of when the parts were removed.

7. Final Inspection

Inspect your machine to ensure that all hardware is tight and components are properly assembled.



Do not use until the machine has been fully assembled and inspected for correct performance in accordance with the Owner's Manual.

NOTICE: This document provides instructions for the replacement of the Tensioner on the Schwinn® 411 / 510e Elliptical.

If you need assistance, please contact Customer Service (if purchased in US/Canada) or your local distributor (if purchased outside US/Canada). To find your local distributor, go to: www.nautilusinternational.com

! This icon means a potentially hazardous situation which, if not avoided, could result in death or serious injury. Read and understand all Warnings on this machine.

Nautilus, Inc., www.NautilusInc.com, 5415 Centerpoint Parkway, Groveport, OH 43125 U.S.A. - Customer Service: North America (800) 605-3369, csnls@nautilus.com | outside U.S. www.nautilusinternational.com | Printed in China | © 2018 Nautilus, Inc. | Schwinn and the Schwinn logo are trademarks owned or licensed by Nautilus, Inc., registered or otherwise protected by common law in the United States and other nations. | **ORIGINAL DOCUMENT - ENGLISH VERSION ONLY**

Important Safety Instructions - Before servicing or using this equipment, obey the following warnings:

! This icon means a potentially hazardous situation which, if not avoided, could result in death or serious injury. Read and understand all Warnings on this machine.

- Read and understand the Part Replacement Procedure before working on the machine. Failure to obey the instructions and safety warnings could cause injury to the service technician or bystanders.
- Keep bystanders, children and pets away from the product being serviced at all times.
- Make sure that the repair is done in an appropriate work space away from foot traffic and exposure to bystanders.
- Disconnect all power and allow to sit for 5 minutes before you service this machine.
- Some components of the equipment can be heavy or awkward. Enlist the service of a second person when you do maintenance steps involving these components. Do not try to do heavy or awkward steps on your own.
- If replacement parts are necessary, use only genuine Nautilus replacement parts and hardware. Failure to use genuine replacement parts can cause a risk to users, keep the machine from operating correctly and will void the warranty.
- Be sure that all warning stickers and instructional placards applied to the product stay present and in good condition when doing maintenance or replacing components. If at any time the Warning labels become loose, unreadable or dislodged, replace the labels. If purchased in US/Canada, contact Customer Service for replacement labels. If purchased outside US/Canada, contact your local distributor for them.
- Do not try to change the design or functionality of the machine being serviced as this can adversely effect user safety and will void the warranty.
- Do not use the machine until all shrouds, instructions, warning labels and correct functionality have been verified and tested for correct performance.

Tools Required (not included)

#2 Phillips screwdriver



Standard screwdriver



6mm hex wrench



10mm open faced wrench



1. Unplug the AC Adapter from the wall outlet and machine.

2. Using a standard screwdriver on the small slots along the edge of the Center Engine Shroud, gently pop it off from the Frame Assembly.



3. Using a #2 Phillips screwdriver, remove the indicated screws (by ovals) from the Right Upper Engine Shroud.

Note: To assist with re-assembly, the double oval is a self-tapping screw.



4. Using a #2 Phillips screwdriver, remove the indicated screws (by ovals) from the Left Upper Engine Shroud.

Note: The Power Inlet is attached to the inside of the Left Upper Engine Shroud. Do not crimp the Power Inlet Cable.

5. Remove the Left Upper Engine Shroud.

6. Using a #2 Phillips screwdriver, remove the 4 screws that attach each of the Lower Engine Shrouds, and remove them.



7. Measure, or mark a piece of scrap paper, the length of the Tensioner Bolt to the Tensioner Nut.

8. Using a 10mm open end wrench, remove the Tensioner Nut from the Tensioner Bolt.

9. Note how the Drive Belt routes through the Tensioner.

10. Using a 6mm hex wrench, remove the Tensioner Hardware.

11. Replace the old Tensioner with the new Tensioner. Be sure the Drive Belt is correctly routed through the new Tensioner and Flywheel.

12. Adjust the Tensioner Nut on the Tensioner Bolt using a 10mm open end wrench to the previous length.

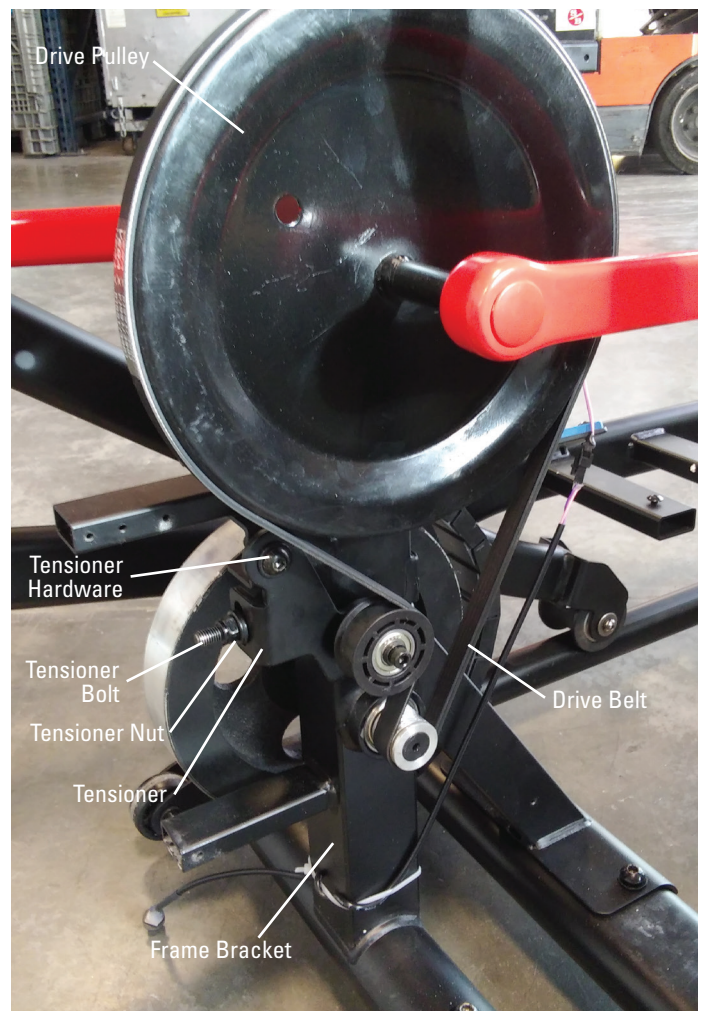

13. To test the Drive Belt tension:

- Push the Drive Belt inward at the midpoint between the pulleys and measure the distance. The Drive Belt should have only 0.25" (0.64 cm) of give.

Or:

- Hold the edges of the Drive Belt at the midpoint and twist it. The Drive Belt should turn only 90 degrees (1/4 turn, to vertical).

If the tension is too loose or too tight, adjust the Tensioner Nut on the Tensioner Bolt.

14. When the tension is correct, tighten the Tensioner Hardware to hold the Tensioner in position.

15. Carefully turn the Right Crank Arm and check the movement of the Drive Belt. The Crank Arms and Flywheel should move as one.

- ⚠ **Be sure to keep fingers clear of all pinch hazards when you turn the Right Crank Arm.**

Adjust the belt tension again if necessary.

16. Re-assemble the machine in the reverse order of when the parts were removed.

17. Final Inspection

Inspect your machine to ensure that all hardware is tight and components are properly assembled.

- ⚠ **Do not use until the machine has been fully assembled and inspected for correct performance in accordance with the Owner's Manual.**



NOTICE: This document provides instructions for the replacement of the Upper and Lower Handlebar Arms on the Schwinn® 411 / 510e Elliptical.

If you need assistance, please contact Customer Service (if purchased in US/Canada) or your local distributor (if purchased outside US/Canada). To find your local distributor, go to: www.nautilusinternational.com

 This icon means a potentially hazardous situation which, if not avoided, could result in death or serious injury. Read and understand all Warnings on this machine.

Nautilus, Inc., www.NautilusInc.com, 5415 Centerpoint Parkway, Groveport, OH 43125 U.S.A. - Customer Service: North America (800) 605-3369, csnls@nautilus.com | outside U.S. www.nautilusinternational.com | Printed in China | © 2018 Nautilus, Inc. | Schwinn and the Schwinn logo are trademarks owned or licensed by Nautilus, Inc., registered or otherwise protected by common law in the United States and other nations. | **ORIGINAL DOCUMENT - ENGLISH VERSION ONLY**

Important Safety Instructions - Before servicing or using this equipment, obey the following warnings:

 This icon means a potentially hazardous situation which, if not avoided, could result in death or serious injury. Read and understand all Warnings on this machine.

- Read and understand the Part Replacement Procedure before working on the machine. Failure to obey the instructions and safety warnings could cause injury to the service technician or bystanders.
- Keep bystanders, children and pets away from the product being serviced at all times.
- Make sure that the repair is done in an appropriate work space away from foot traffic and exposure to bystanders.
- Disconnect all power and allow to sit for 5 minutes before you service this machine.
- Some components of the equipment can be heavy or awkward. Enlist the service of a second person when you do maintenance steps involving these components. Do not try to do heavy or awkward steps on your own.
- If replacement parts are necessary, use only genuine Nautilus replacement parts and hardware. Failure to use genuine replacement parts can cause a risk to users, keep the machine from operating correctly and will void the warranty.
- Be sure that all warning stickers and instructional placards applied to the product stay present and in good condition when doing maintenance or replacing components. If at any time the Warning labels become loose, unreadable or dislodged, replace the labels. If purchased in US/Canada, contact Customer Service for replacement labels. If purchased outside US/Canada, contact your local distributor for them.
- Do not try to change the design or functionality of the machine being serviced as this can adversely effect user safety and will void the warranty.
- Do not use the machine until all shrouds, instructions, warning labels and correct functionality have been verified and tested for correct performance.

Tools Required (not included)

#2 Phillips screwdriver



4mm hex wrench
(2) 6mm hex wrenches



1. Unplug the AC Adapter from the wall outlet and machine.

2. Remove the Pivot Shroud from the Frame Assembly.

3. Using a 4mm hex wrench, remove the indicated hardware (by ovals) that connects the Upper Handlebar Arms to the Lower Handlebar Arms.

4. Remove the Upper Handlebar Arms from the Frame Assembly.



5. Using two 6mm hex wrenches, remove the hardware that connects the Lower Handlebar Arms to the Pedal Arms (indicated by arrow for the right side).



6. Using a #2 Phillips screwdriver, remove the two screws that secure the Handlebar Shrouds.

7. Remove the Handlebar Shrouds from the Frame Assembly.



8. Using two 6mm hex wrenches, remove the indicated hardware (by arrows) that attaches the Lower Handlebar Arms to the Frame Assembly.

9. Carefully remove the Lower Handlebar Arms from the Frame Assembly and place outside the work area.



10. Re-assemble the machine in the reverse order of when the parts were removed.

11. Final Inspection

Inspect your machine to ensure that all hardware is tight and components are properly assembled.

⚠ Do not use until the machine has been fully assembled and inspected for correct performance in accordance with the Owner's Manual.

NOTICE: This document provides instructions for the replacement of the Transport Wheel on the Schwinn® 411 / 510e Elliptical.

If you need assistance, please contact Customer Service (if purchased in US/Canada) or your local distributor (if purchased outside US/Canada). To find your local distributor, go to: www.nautilusinternational.com

 This icon means a potentially hazardous situation which, if not avoided, could result in death or serious injury. Read and understand all Warnings on this machine.

Nautilus, Inc., www.NautilusInc.com, 5415 Centerpoint Parkway, Groveport, OH 43125 U.S.A. - Customer Service: North America (800) 605-3369, csnls@nautilus.com | outside U.S. www.nautilusinternational.com | Printed in China | © 2018 Nautilus, Inc. | Schwinn and the Schwinn logo are trademarks owned or licensed by Nautilus, Inc., registered or otherwise protected by common law in the United States and other nations. | **ORIGINAL DOCUMENT - ENGLISH VERSION ONLY**

Important Safety Instructions - Before servicing or using this equipment, obey the following warnings:

 This icon means a potentially hazardous situation which, if not avoided, could result in death or serious injury. Read and understand all Warnings on this machine.

- Read and understand the Part Replacement Procedure before working on the machine. Failure to obey the instructions and safety warnings could cause injury to the service technician or bystanders.
- Keep bystanders, children and pets away from the product being serviced at all times.
- Make sure that the repair is done in an appropriate work space away from foot traffic and exposure to bystanders.
- Disconnect all power and allow to sit for 5 minutes before you service this machine.
- Some components of the equipment can be heavy or awkward. Enlist the service of a second person when you do maintenance steps involving these components. Do not try to do heavy or awkward steps on your own.
- If replacement parts are necessary, use only genuine Nautilus replacement parts and hardware. Failure to use genuine replacement parts can cause a risk to users, keep the machine from operating correctly and will void the warranty.
- Be sure that all warning stickers and instructional placards applied to the product stay present and in good condition when doing maintenance or replacing components. If at any time the Warning labels become loose, unreadable or dislodged, replace the labels. If purchased in US/Canada, contact Customer Service for replacement labels. If purchased outside US/Canada, contact your local distributor for them.
- Do not try to change the design or functionality of the machine being serviced as this can adversely effect user safety and will void the warranty.
- Do not use the machine until all shrouds, instructions, warning labels and correct functionality have been verified and tested for correct performance.

Tools Required (not included)

13mm open faced wrench



6mm hex wrench



1. Unplug the AC Adapter from the wall outlet and machine.



2. Using a 13mm open faced wrench and a 6mm hex wrench, remove the hardware (indicated by arrows) that secures the Transport Wheel to the Rail Assembly.

3. Remove the old Transport Wheel and replace with the new Transport Wheel.

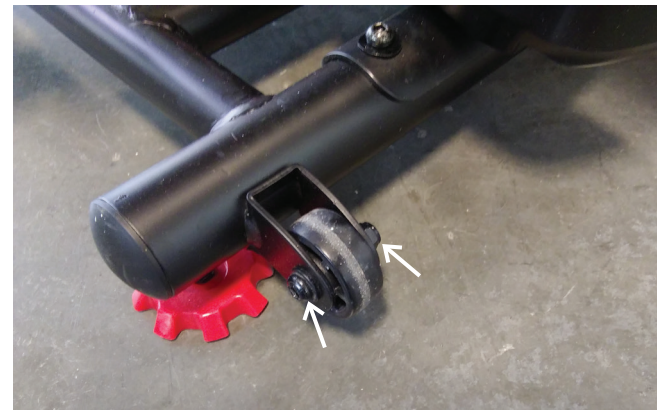

4. Re-assemble the machine in the reverse order of when the parts were removed.

5. Final Inspection

Inspect your machine to ensure that all hardware is tight and components are properly assembled.

⚠ Do not use until the machine has been fully assembled and inspected for correct performance in accordance with the Owner's Manual.